

1 Description

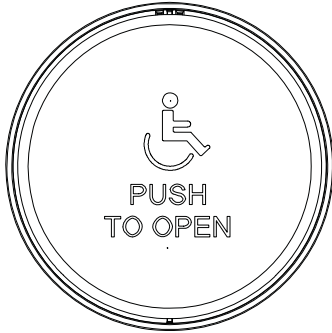

6" ROUND
8310-852TWP (shown)
8310-852WP (not shown)



4.75" SQUARE
8310-853TWP (not shown)
8310-853WP (shown)

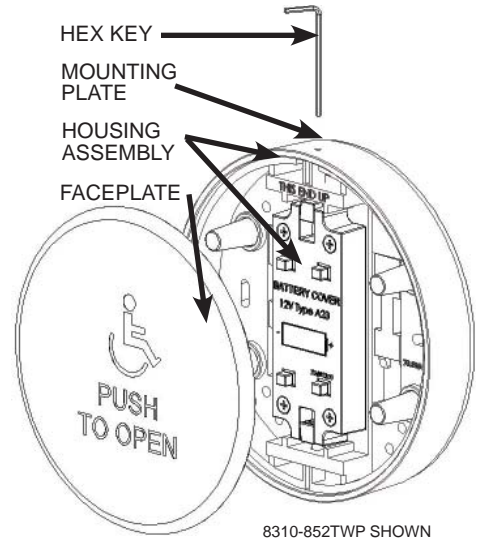

2 Specifications

DESCRIPTION	SPECIFICATION
DIMENSIONS	6" Round: 6.33"R X 1.45"D (160.80m X 36.87mm) 4.75" Square: 5.12"H X 5.12"W X 1.42"D (130.0mm X 130.0mm X 36.1mm)
WEIGHT	6" Round: 1.2 lbs (0.54 kg) 4.75" Square: 1.04 lbs (0.47 kg)
MATERIAL	ABS Plastic and Stainless Steel
FREQUENCY	433 MHz
CERTIFICATION	FCC

3 Precautions



- Shut off all power going to header before attempting any wiring procedures.
- Maintain a clean & safe environment when working in public areas.
- Constantly be aware of pedestrian traffic around the door area.
- Always stop pedestrian traffic through the doorway when performing tests that may result in unexpected reactions by the door.
- ESD electrostatic discharge: Circuit boards are vulnerable to damage by electrostatic discharge. Before handling any board ensure you dissipate your body's charge.
- Always check placement of all wiring before powering up to insure that moving door parts will not catch any wires and cause damage to equipment.
- Ensure compliance with all applicable safety standards (i.e. ANSI A156.10/19) upon completion of installation.
- DO NOT attempt any internal repair of the sensor. All repairs and/or component replacements must be performed by LCN, Inc. Unauthorized disassembly or repair:
 1. May jeopardize personal safety and may expose one to the risk of electrical shock.
 2. May adversely affect the safe and reliable performance of the product will result in a voided product warranty.

4 Installation

1 Mounting the Pushplate

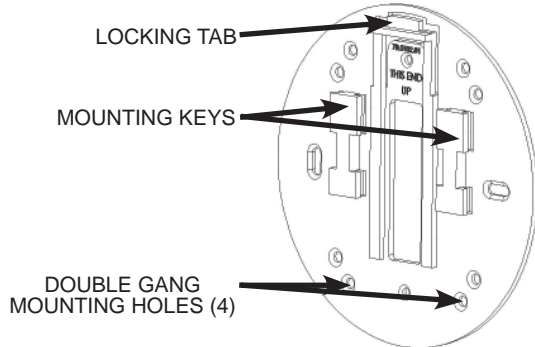

The Wireless Pushplate may be mounted WITH or WITHOUT the mounting plate. To use the mounting plate, screw a minimum of two (2) screws into a solid surface through the holes in the mounting plate (#8 countersunk head screws must be used). The mounting plate must be mounted so that the text side is facing up.

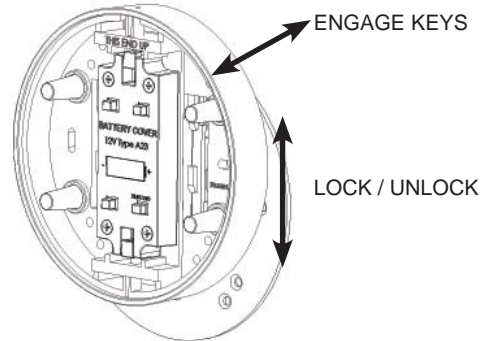

To attach the housing to the mounting plate, place the housing over the key tabs on the mounting plate and then slide the plate downward until the locking tab engages the housing. To remove the housing, press in the locking tab and reverse this procedure.

NOTE: To securely lock the plate, put an additional screw through both the housing and the mounting plate.

2 Pushplate Function

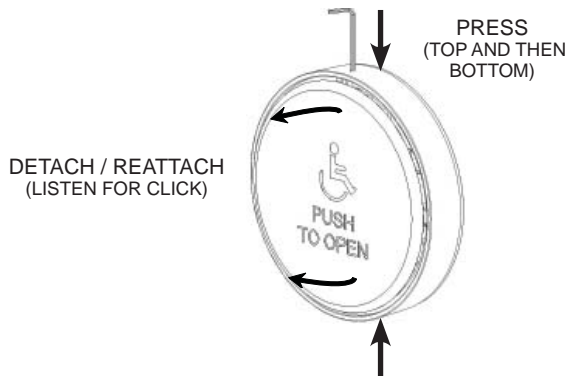

To assemble or disassemble the pushplate, use the enclosed hex key (or similar diameter tool) to press in and release the spring clips from the housing. The spring clip will need to be engaged / disengaged from the top and bottom, one at a time. When the spring clips are correctly engaged, they will make a CLICK. It may be necessary to rotate the faceplate slightly to have them lock correctly.

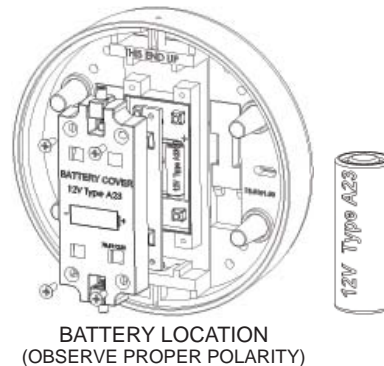

To replace the battery, remove the faceplate and the four (4) screws holding the battery cover to expose the transmitter assembly. Replace the battery with a fresh 12V (A23) battery and reassemble the pushplate.

WARNING: DO NOT OVER TIGHTEN THE SCREWS ON THE BATTERY COVER. THIS MAY CAUSE THE TRANSMITTER TO BE IN CONSTANT ACTIVATION. THE HEAD OF THE SCREWS SHOULD BE FLUSH WITH THE TOP OF THE PLASTIC COVER.

3 Receiver Setup

For complete Receiver (8310-865, sold separately) Setup & Installation procedures, refer to LCN publication 75.5315 (433MHz Transmitters & Receiver User's Guide).

5 Company Contact



Do not leave problems unresolved. If a satisfactory solution cannot be achieved after troubleshooting a problem, please contact LCN at 1-800-526-2400. If you must wait for the following workday to call LCN, leave the door inoperable until satisfactory repairs can be made. Never sacrifice the safe operation of the automatic door or gate for an incomplete solution.

For more information, visit www.lcn.ingersollrand.com.

Appendix - Wiring Diagram

8310-865 RF RECEIVER SINGLE DOOR WIRING

