



7116 Exit Alarm Installation Instructions

These instructions pertain to 7116 alarm assemblies shipped after October 2012.
For units shipped prior, please refer to 80-9470-7116-000.
See section "A" for instructions on updating an alarm assembly shipped prior to October 2012.
See section "B" for installation instructions for where an existing alarm assembly is not present.

Section A

The following instructions should be used when updating an existing alarm assembly.

Existing Touchbar Switch Disassembly

1

After removing device from door, slide existing alarm cover and rail sleeve out (Fig. A).

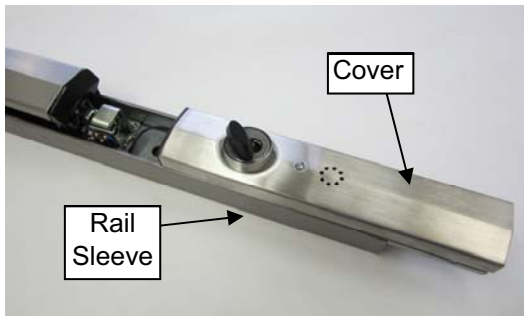

Figure A

2

After removing the existing cover and sleeve, unscrew the one screw shown on Fig. B.



Figure B

1



3

Remove the touchbar switch (Fig. C), which will be wired to the existing alarm cover assembly as shown below (Fig. D). Discard the screw.

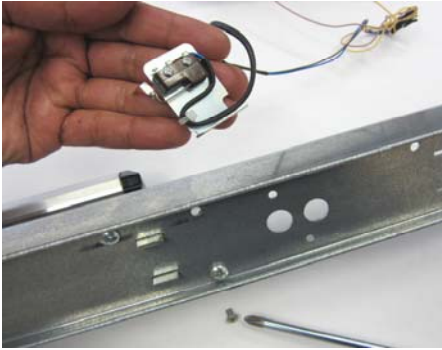

Figure C

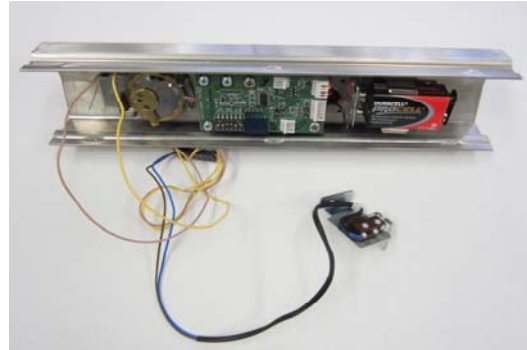

Figure D

4

Remove cylinder nut by turning counter-clockwise using the provided grips (Fig. E). You may use a flat screwdriver, tapping it with a hammer until loose enough to turn with fingers.

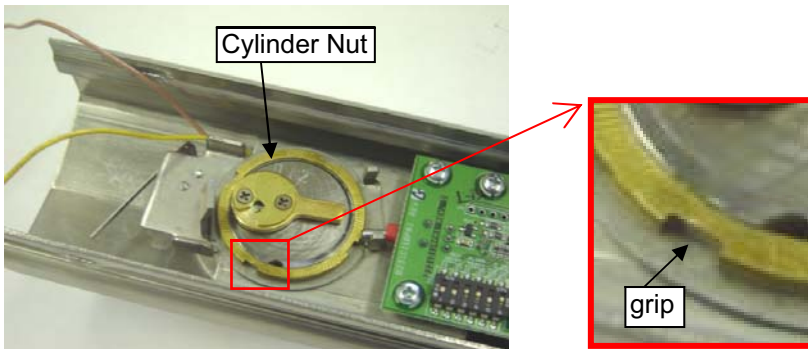

Figure E

5

Discard old alarm assembly. Save the cover, the cylinder and the parts that hold the cylinder in place (Fig. F). These last items may not be provided with the new alarm kit.

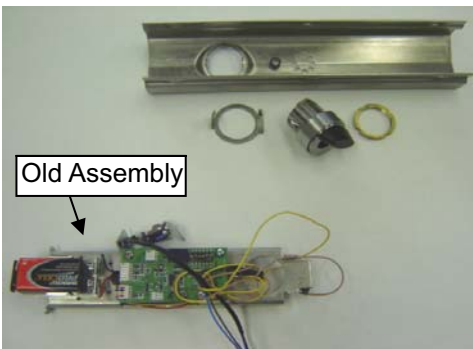

Figure F

6

Slide rail sleeve back on and re-install exit bar to the door. Now you are ready to install the new alarm assembly. See Section B.

Section B

The following instructions should be used for installation where an existing alarm assembly is not present.

Components

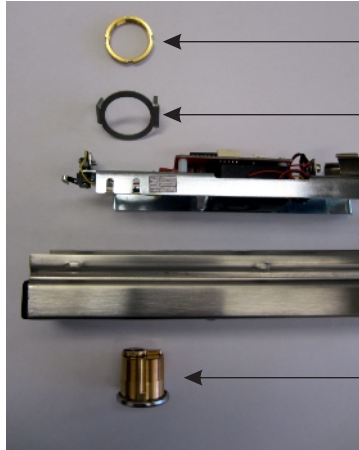

Figure 1-a

Cylinder Nut:
60-7700-2212-000

Arming Switch:
60-7700-7214-999

7116 Alarm Assembly:
60-7700-0987-999

End Cover:
60-7700-7215 (for 36")

Cylinder



Figure 1-b

Switch Activator:
60-7700-9003

Alarm Cover Assembly (60-7700-0984-xxx)

1

Inspect the alarm board assembly to make sure wires are routed as shown in Figure 2.

Red and Yellow wires held around housing tab and around the frame's edge

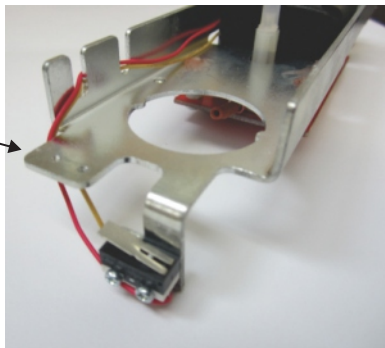

Figure 2

2

Slide the alarm board assembly into the cover as shown in Figure 3. Make sure the LED aligns with the opening on the cover.

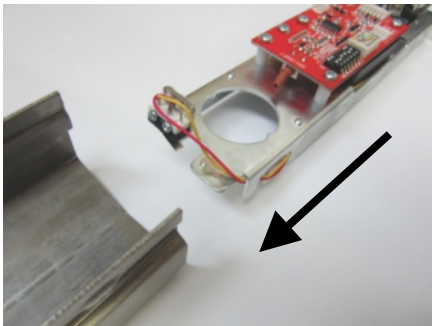

Figure 3

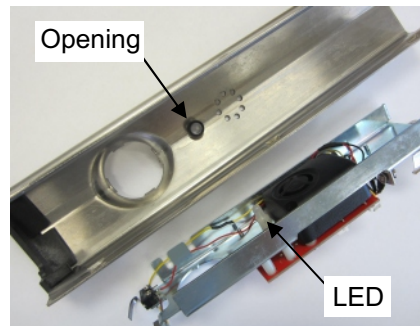

Figure 4

3

3

Position the arming switch over the cylinder opening as shown on Figure 5. Make sure the alarm's toggle switch is between the two posts as shown.

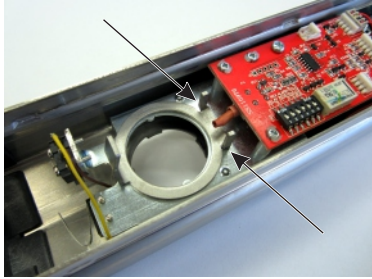

Figure 5

4

Holding the Arming switch in place, insert the cylinder as shown on Figure 6. Make sure the cam is pointing towards the alarm board.

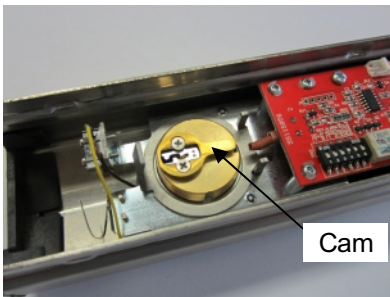

Figure 6

5

Secure the cylinder with the cylinder nut. Make sure the lip of the nut is facing up (Fig.7) and the arming switch is free to rotate after the cylinder is secured (Fig.8)

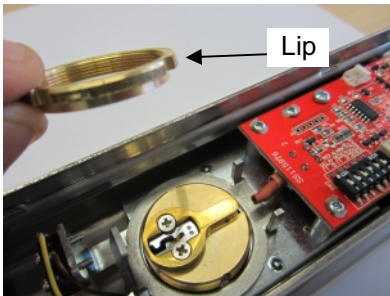

Figure 7

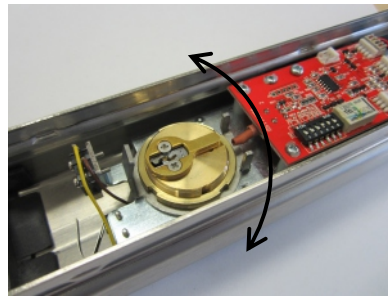

Figure 8

Switch Activator Installation

6

Install the switch activator making sure it's secure on the flange and the pin of the bar mechanism (Fig. 9-b). The Activator' tail should move up when the bar is depressed.

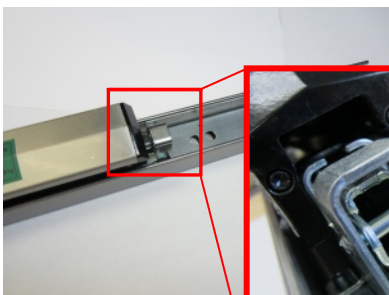

Figure 9-a

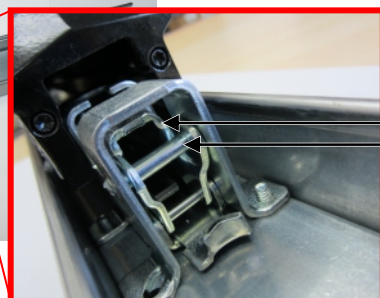

Figure 9-b

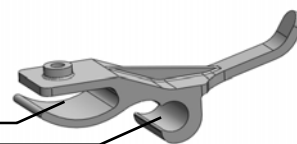

Figure 9-c

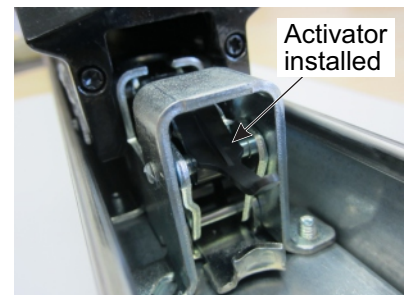

Figure 10

4

Cover Installation

7

Take the alarm cover (60-7700-0984-xxx) as completed in section 'B' and slide it into the rail as shown in Figure 11. Make sure the activator's tail slide over the alarm switch (Fig.12).

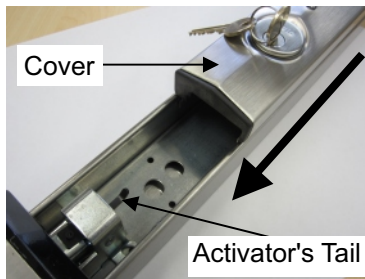

Figure 11

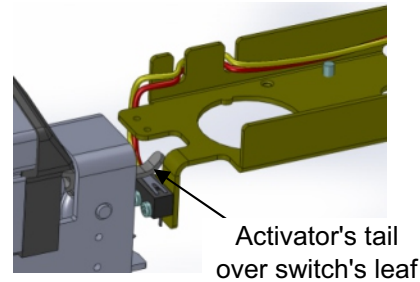

Figure 12

Battery Installation

8

Install 9V battery as shown in Figure 13. Make sure it's well secured in the battery holding bracket.

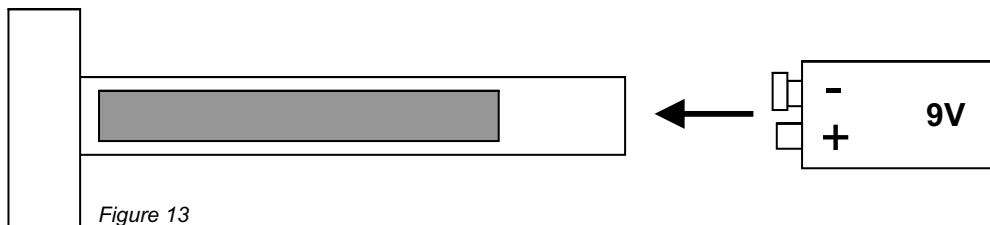

Figure 13

9

Test the alarm:

- 1- Rotate key clockwise to arm the alarm. Wait 20 sec. for the confirmation chirp.
- 2- Depress the touch pad. The alarm should be activated by this act.
- 3- Turn key counter-clockwise to turn the alarm off.
- 4- Rotate key clockwise to arm the alarm. Wait 20 sec. for the confirmation chirp.
- 5- Slide the cover out with the intention to remove it. The alarm should be activated by this act.
- 6- Turn key counter-clockwise to turn the alarm off.
- 7- If there were problems activating the alarm refer to Troubleshooting (Section 'F')
- 8- If the alarm was activated successfully on steps #2 & #5, the test is completed.

Troubleshooting

1- WIRES & SWITCHES

- a. If the wires are loose or not routed correctly, please re-route using Figure 2 as a reference before installation.
- b. If wires or switch leafs are broken the alarm assembly has to be replaced before installation.

2- ARMING SWITCH NOT ROTATING

- a. If the arming switch is not free to rotate the nut may be upside down. Make sure the "lip" is up to prevent compression on the arming switch.
- b. If the arming switch is not free to rotate, yet the nut is correctly installed, loosen up the nut 1/4 of a turn. Check the arming switch again.

5

Troubleshooting continued...

3- SWITCH ACTIVATOR OUT OF POSITION

- a. If the tail of the switch activator is lower than the Touchbar switch, carefully pull up the tail by hand until it is slightly above the switch. Lift gently to prevent damage to either the switch or the activator arm.
- b. If the tail of the switch activator is too high to make contact with the Touchbar switch insert a thread forming screw M2.5 x 5 as shown in Figure 14-a. Turn the screw as needed in order to lift the front of the activator off the metal; this should lower the tail enough to ensure proper switch contact (Fig. 14-b).

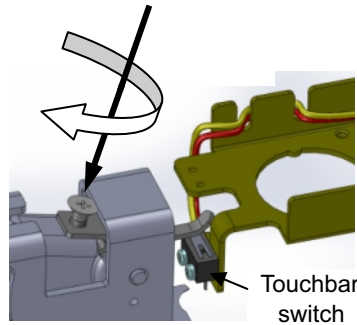

Figure 14-a

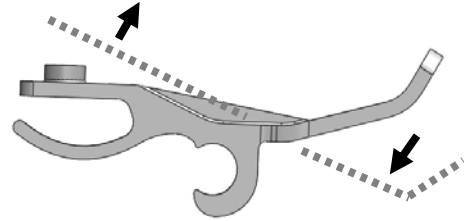

Figure 14-b

4- ALARM WILL NOT SOUND

- a. Battery not well connected.
- b. Battery needs to be replaced.
- c. Alarm is not armed. Turn key clockwise.

5- ALARM SOUNDS WHEN KEYSWITCH IS ACTIVATED

- a. Activator may not be installed correctly. Refer to Troubleshooting step #3.
- b. Tamper switch (Fig. 14-a) may not be closing when alarm end cover is installed. Make sure the leaf is being depressed by the mechanism frame as shown on Figure 12.
- c. J2 connector may be disconnected or loose (see Fig. 15).

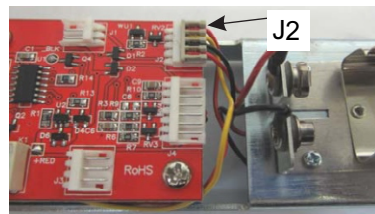

Figure 15

6- ALARM CHIRPS EVERY 30 SECONDS

- a. Low battery indicator, replace battery.

NOTE: For other issues, please refer to Installation Instructions 80-9470-7116-000

Yale Locks & Hardware

Product Support Tel 800.810.WIRE (9473) • www.yalelocks.com

Yale Locks & Hardware is a division of Yale Security Inc., an ASSA ABLOY Group company.

Yale® is a registered trademark of Yale Security Inc., an ASSA ABLOY Group company. Other products' brand names may be trademarks or registered trademarks of their respective owners and are mentioned for reference purposes only. These materials are protected under U.S. copyright laws. All contents current at time of publication.

Yale Security Inc. reserves the right to change availability of any item in this catalog, its design, construction, and/or its materials.

Copyright © 2012, 2013 Yale Security Inc., an ASSA ABLOY Group company.

All rights reserved. Reproduction in whole or in part without the express written permission of Yale Security Inc. is prohibited.