

INSTALLATION INSTRUCTIONS

THE CLOUD: BLIND CORNER ORGANIZER

TOOLS REQUIRED:

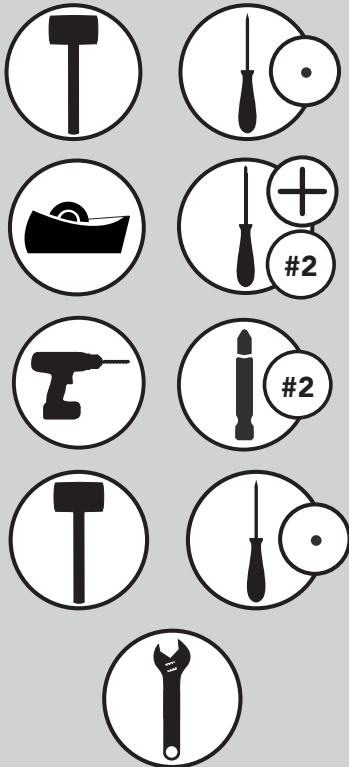

ESTIMATED ASSEMBLY TIME:

SINGLE TRAY APPLICATION
30 MIN

DOUBLE TRAY APPLICATION
60 MIN

CARE AND MAINTENANCE:

Clean with a damp cloth and wipe parts dry.



Parts List		Sgl Tier	2-Tier
No.	Description	Qty	Qty
1	Cloud Tray	1	2
2	Guide Track	1	2
3	Support Arm Plastic Cap	1	2
4	Plastic Tray Stop	2	4
5	Support Arm	1	2
6	Pivot Guide	1	2
7	Support Arm Screws	6	12
8	Guide Track Wood Screws	14	14
9	Soft-Close Ball Stud Screws	3	6
10	Support Arm Ball Stud	1	2
11	Support Arm Soft Close Piece	1	2
12	Soft-Close Piston	1	2
13	Soft-Close Tray Ball Stud	1	2
14	Guide Track Machine Screws	N/A	14
15	Top Shelf Support Pivot Screw	N/A	1
16	Side Bracket/Positioner Screws	N/A	17
17	2-Tier Hardware Set	N/A	1
18	2-Tier Top Shelf Support	N/A	1
19	Telescoping Shaft	N/A	1

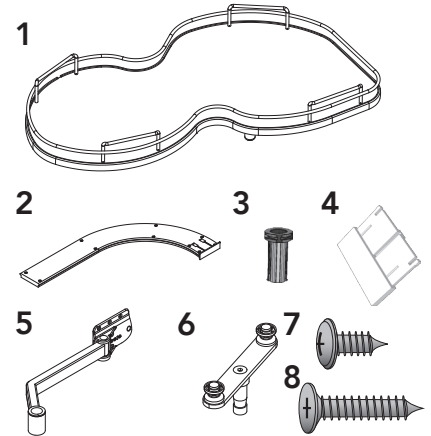

PARTS 7-10 COME WITH SOFT-CLOSE HARDWARE BOX (SOLD SEPARATELY)

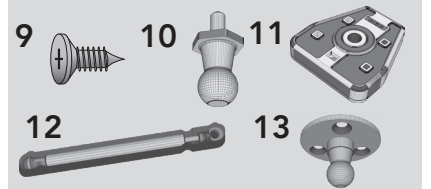

PARTS 11-16 COME WITH 2-TIER VERSION ONLY

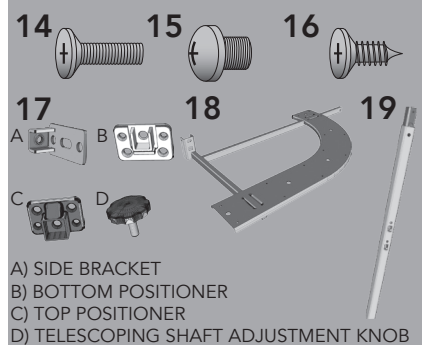

NOTE:

THIS PRODUCT HAS 3 CONFIGURATIONS THAT HAVE SEPARATE INSTALLATION REQUIREMENTS. DETERMINE WHERE TO BEGIN YOUR INSTRUCTIONS BELOW:

SINGLE TIER VERSION – BEGIN ON PAGE 2

DOUBLE SINGLE TIER VERSION – BEGIN ON PAGE 4

TWO-TIER VERSION – BEGIN ON PAGE 6

NOTE:

FOR FACE FRAME CABINET APPLICATIONS, YOU WILL NEED A WOODEN PIECE TO SCAB OUT THE SIDE WALL OF THE CABINET, MAKING IT FLUSH WITH THE CABINET OPENING SO THE SUPPORT ARM CAN BE PROPERLY INSTALLED. (DETAILS INSIDE)

SINGLE TIER CLOUD INSTALLATION

STEP 1

The Cloud blind corner organizer can be used for both left door/blind right or right door/blind left applications. Refer to Figure 1.1 to determine your cabinet orientation. The figures in this booklet use left door/blind right examples. If you're installing in a right door/blind left application, the reverse of the figures in this booklet will be true for your cabinet.

If your cabinet is frameless, proceed to Step 2. If it is a face frame cabinet, you will need to scab your side wall in order to make it flush with the cabinet opening. Measure the width between the side wall and cabinet opening to determine how thick your wooden piece should be. The piece needs to be at least 10" deep in order to accommodate the support arm (See Figure 1.2).

FIGURE 1.1

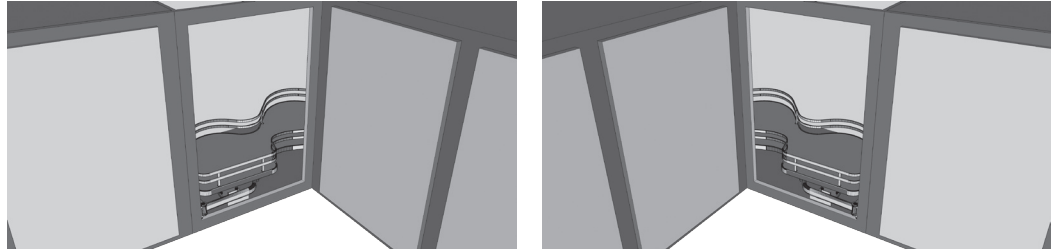

LEFT DOOR/BLIND RIGHT

RIGHT DOOR/BLIND LEFT

FIGURE 1.2

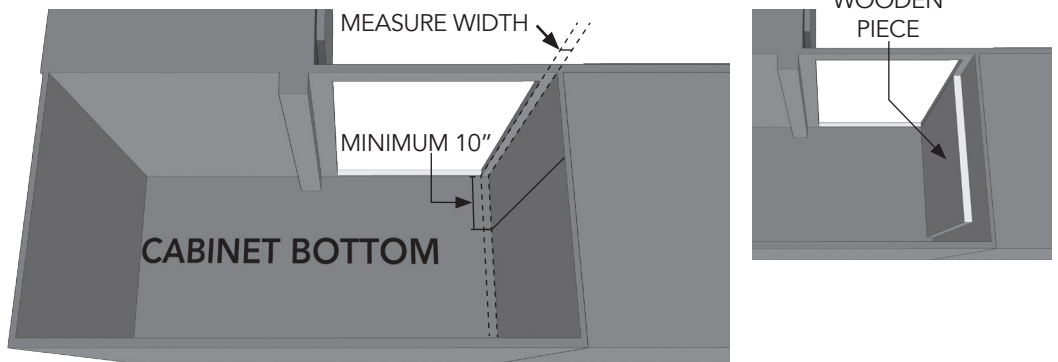

STEP 2

Place the support arm template against your cabinet sidewall furthest away from the blind area (See Figure 2). Follow the instructions on the template for placement. Use tape if necessary to affix the template to the cabinet wall while punching holes.



FIGURE 2

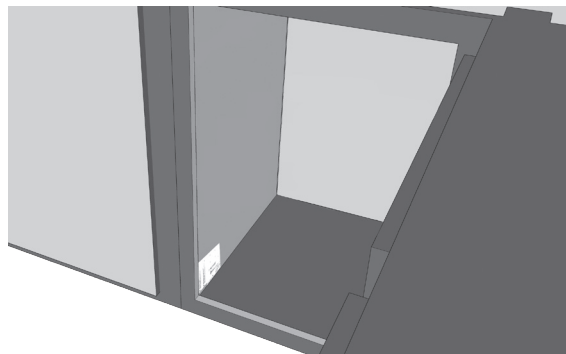

STEP 3

Using an awl and rubber mallet, punch holes to assist in securing your fasteners. Remove the template when done (See Fig 3).



FIGURE 3

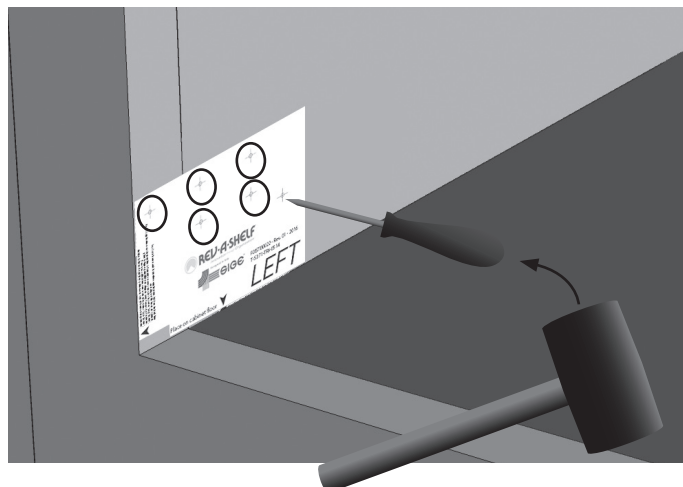

STEP 4

Place the guide track template on your cabinet floor. Follow the directions on the template to orient the template correctly. Secure template to the floor with tape and punch pilot holes with your awl and rubber mallet (See Fig 4).



FIGURE 4

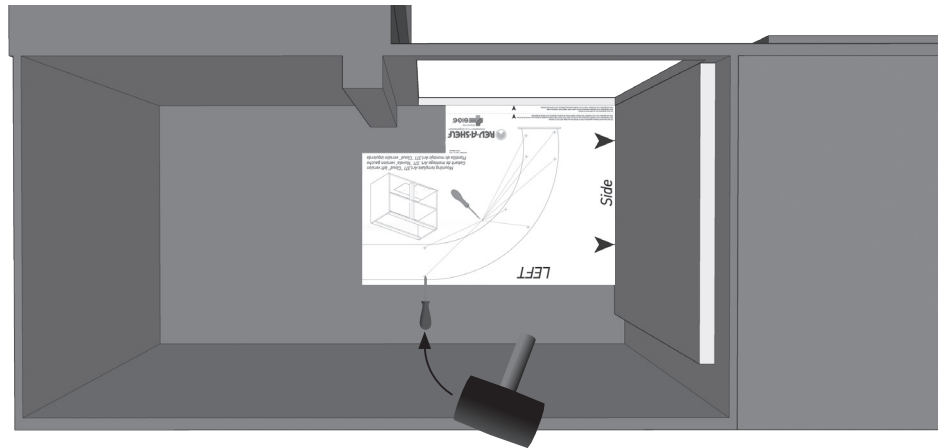

STEP 5

Using the provided support arm screws, secure the support arm to the cabinet side wall (See Fig 5). At this time, insert the plastic cap into the support arm as shown.



FIGURE 5

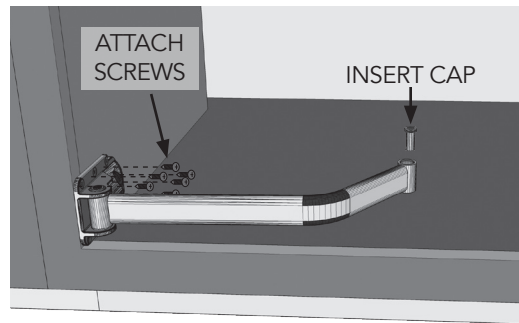

STEP 6

Using the provided guide track wood screws, secure the guide track to the cabinet floor (See Fig 6).



FIGURE 6

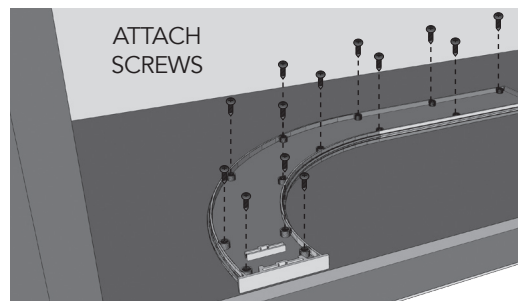
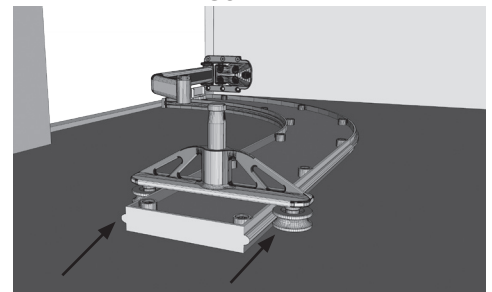

FIGURE 7



SLIDE PIVOT GUIDES HERE

Slide the pivot guide onto the guide tracks. (See Fig 7)

STEP 7



IF YOU INTEND TO INSTALL THE SOFT-CLOSE KIT, TURN TO PAGE 10 AT THIS TIME. OTHERWISE, PROCEED TO STEP 8 AND CONTINUE YOUR INSTALLATION.



STEP 8

Align the tray over the top of the pivot guide and support arm. Insert the tray into the corresponding attachments and press firmly into place (See Fig 8).

FIGURE 8

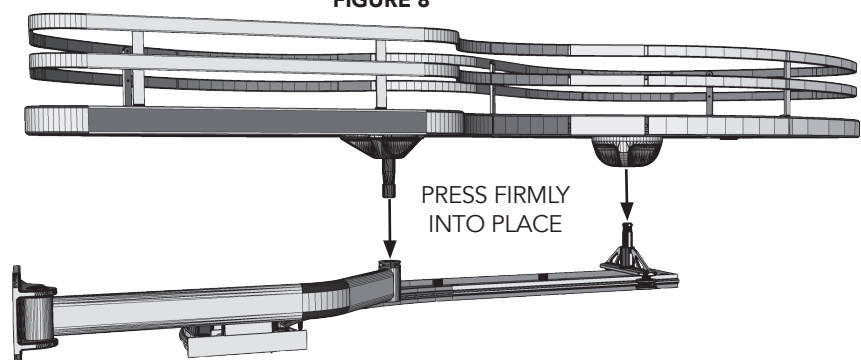

DOUBLE SINGLE TIER CLOUD INSTALLATION

STEP 1

The Cloud blind corner organizer can be used for both left door/blind right or right door/blind left applications. Refer to Figure 1.1 to determine your cabinet orientation. The figures in this booklet use left door/blind right examples. If you're installing in a right door/blind left application, the reverse of the figures in this booklet will be true for your cabinet.

If your cabinet is frameless, proceed to Step 2. If it is a face frame cabinet, you will need to scab your side wall on both tiers of your cabinet in order to make it flush with the cabinet opening. Measure the width between the side wall and cabinet opening to determine how thick your wooden pieces should be. The pieces need to be at least 10" deep in order to accommodate the support arms (See Figure 1.2).

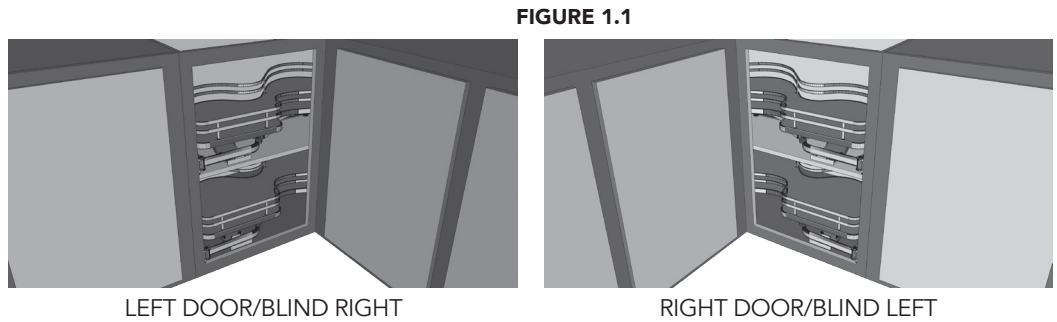

FIGURE 1.1

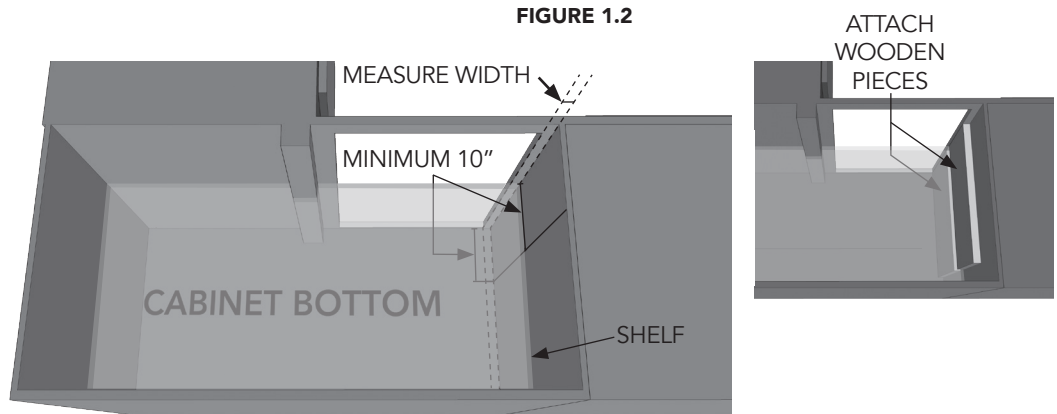

FIGURE 1.2

STEP 2

Place the support arm template against your cabinet sidewall furthest away from the blind area (See Figure 2). Follow the instructions on the template for placement. Use tape if necessary to affix the template to the cabinet wall while punching holes. Repeat this step for the upper shelf.

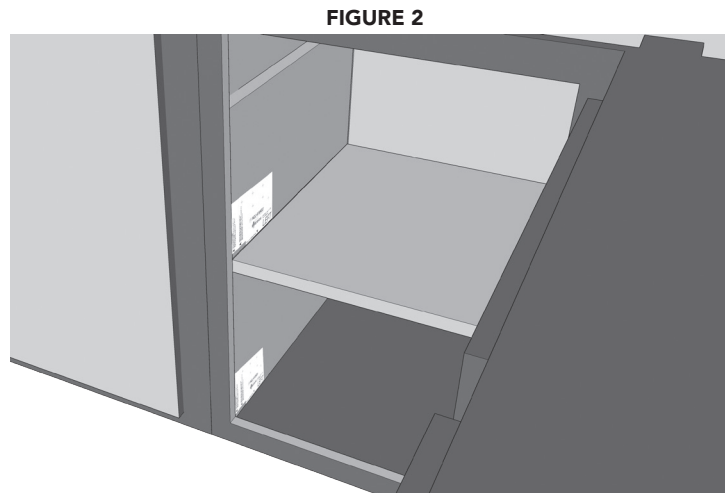

FIGURE 2



STEP 3

Using an awl and rubber mallet, punch holes to assist in securing your fasteners. Remove the template when done (See Fig 3).

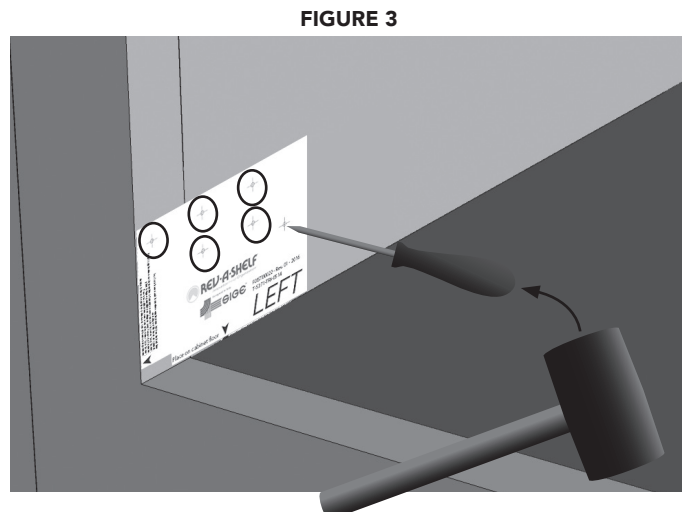

FIGURE 3



STEP 4

Place the guide track template on your cabinet floor. Follow the directions on the template to orient the template correctly. Secure template to the floor with tape and punch pilot holes with your awl and rubber mallet (See Fig 4). Repeat this step for the shelf where the upper tray will go.



FIGURE 4

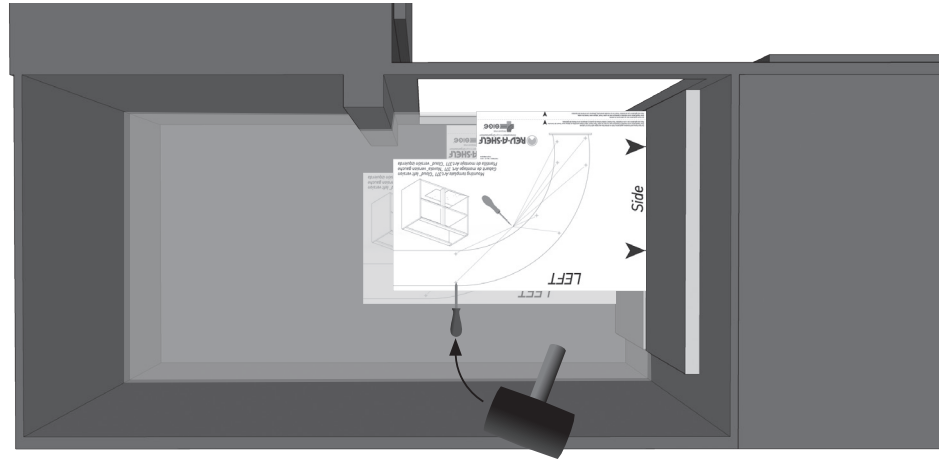

STEP 5

Using the provided support arm screws, secure the arm supports to the cabinet side wall using your punched holes as a guide (See Fig 5). At this time, insert the plastic cap into the support arm as shown.



FIGURE 5

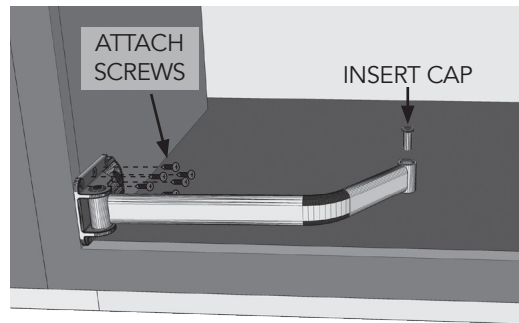

STEP 6

Using the provided guide track wood screws, secure the guide tracks to the cabinet floor and shelf (See Fig 6).



FIGURE 6

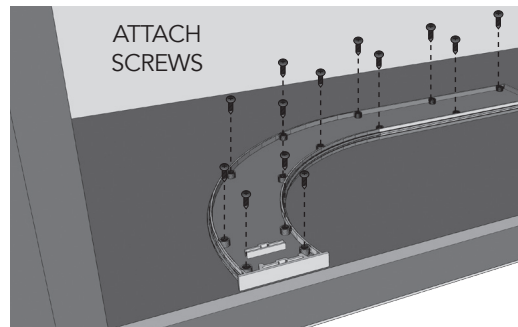
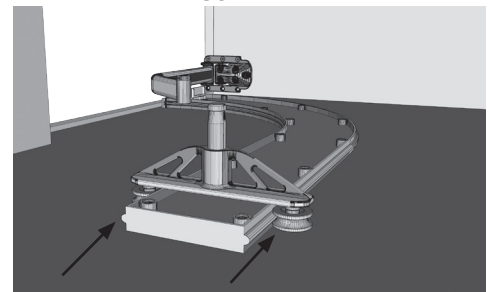

FIGURE 7



STEP 7

Slide the pivot guides onto the guide tracks (See Fig 7).



IF YOU INTEND TO INSTALL THE SOFT-CLOSE KIT, TURN TO PAGE 10 AT THIS TIME. OTHERWISE, PROCEED TO STEP 8 AND CONTINUE YOUR INSTALLATION.



STEP 8

Align the tray over the top of the pivot guide and support arm. Insert the tray into the corresponding attachments and press firmly into place

NOTE: Repeat steps 5-8 for the second tray.

FIGURE 8

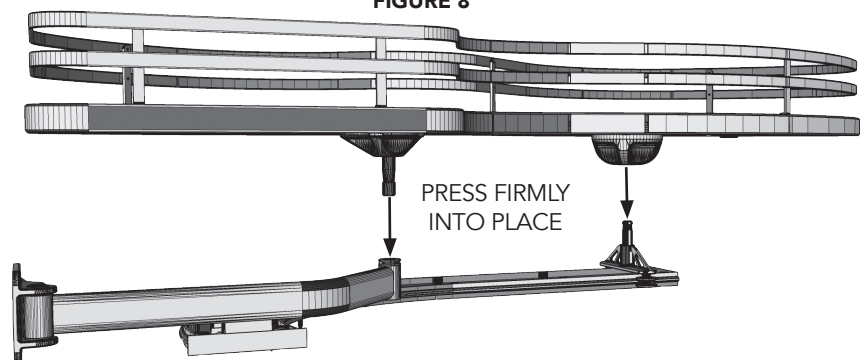

2-TIER CLOUD INSTALLATION STEP 1

The Cloud blind corner organizer can be used for left door/blind right or right door/blind left applications. Refer to Figure 1.1 to determine your cabinet orientation. The figures in this booklet use left door/blind right examples. If you're installing in a right door/blind left application, the reverse of the figures in this booklet will be true for your cabinet.

If your cabinet is frameless, proceed to Step 2. If it is a face frame cabinet, you will need to scab your side wall in order to make it flush with the cabinet opening. Measure the width between the side wall and cabinet opening to determine how thick your wooden piece should be. The piece needs to be at least 10" deep 20" tall in order to accommodate both support arms (See Figure 1.2).

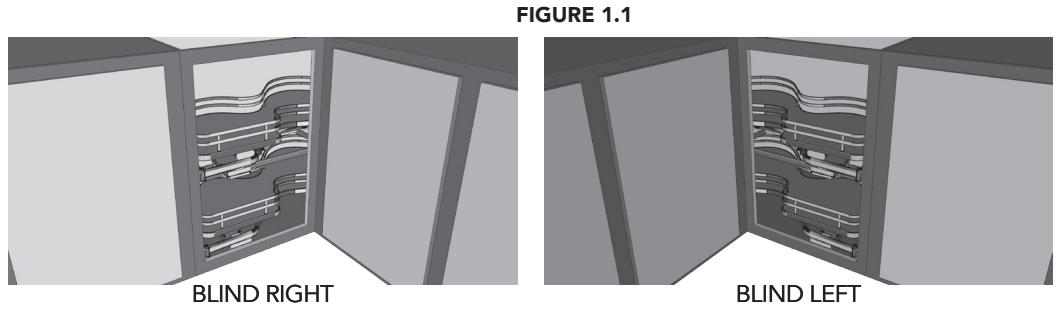

FIGURE 1.1

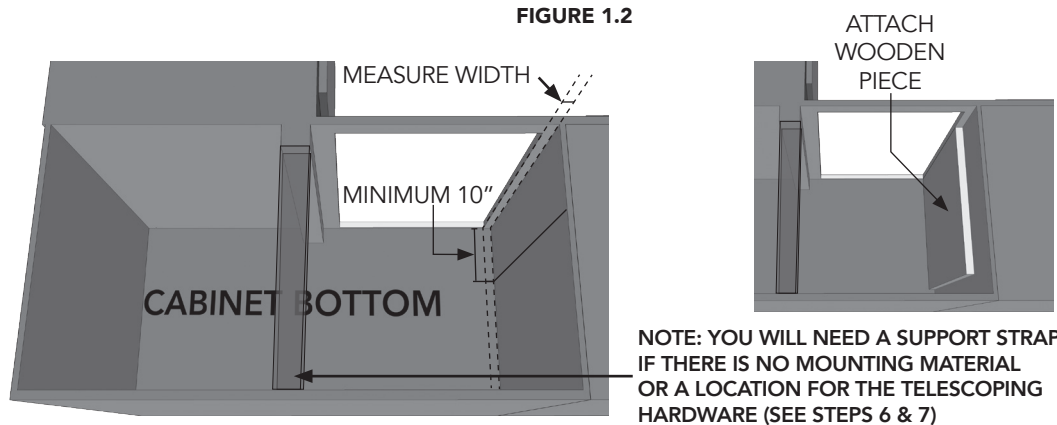

FIGURE 1.2

NOTE: YOU WILL NEED A SUPPORT STRAP IF THERE IS NO MOUNTING MATERIAL OR A LOCATION FOR THE TELESCOPING HARDWARE (SEE STEPS 6 & 7)

STEP 2

Place the support arm template against your cabinet sidewall furthest away from the blind area (See Figure 2). Follow the instructions on the template for placement. Use tape if necessary to affix the template to the cabinet wall while punching holes.

NOTE: Keep this template handy, as you will use it for the upper tray in Step 9.



STEP 3

Using an awl and rubber mallet, punch holes to assist in securing your fasteners. Remove the template when done (See Fig 3).

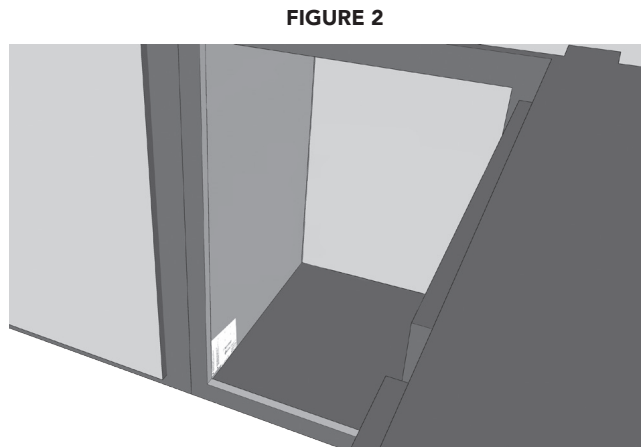

FIGURE 2

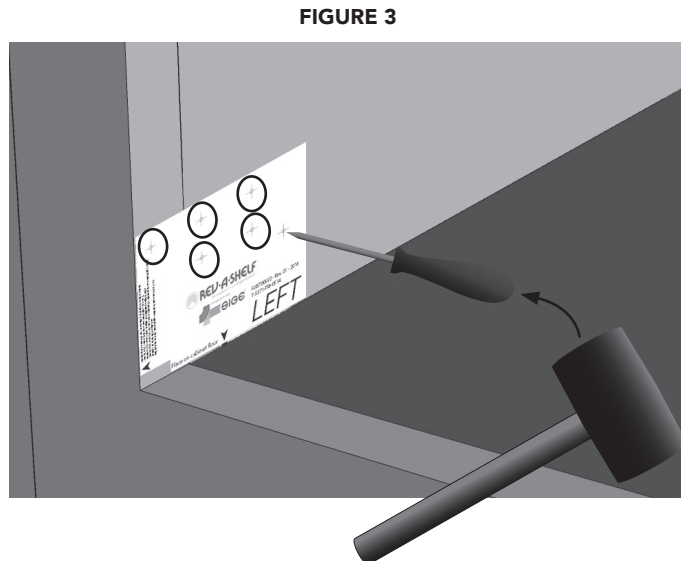

FIGURE 3

STEP 4

Place the guide track template on your cabinet floor. Follow the directions on the template to orient the template correctly. Secure template to the floor with tape and punch pilot holes with your awl and rubber mallet (See Fig 4).



FIGURE 4

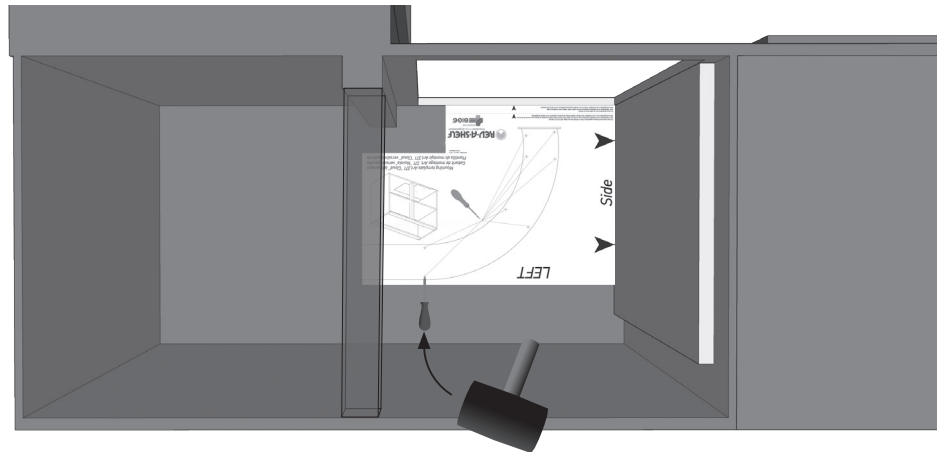

STEP 5

Remove the guide track template and replace with the telescoping shaft template. Secure in place with tape and punch your hole locations with an awl and rubber mallet (See Fig 5.1). Turn the template upside down repeat for the cabinet ceiling (See Fig 5.2).



FIGURE 5.1

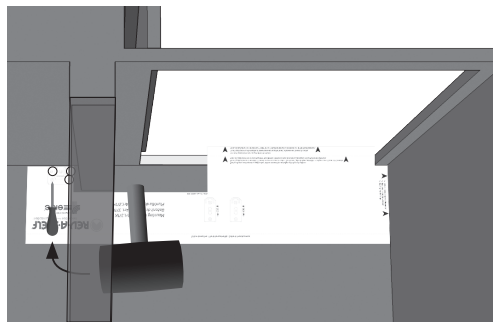

FIGURE 5.2

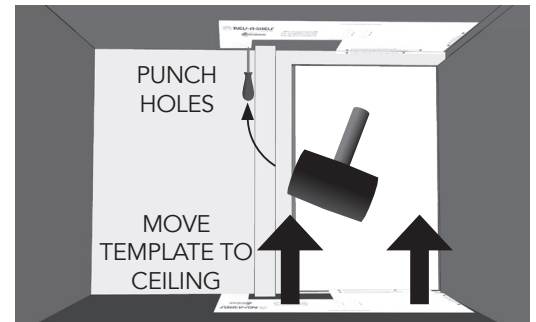

FIGURE 6.1

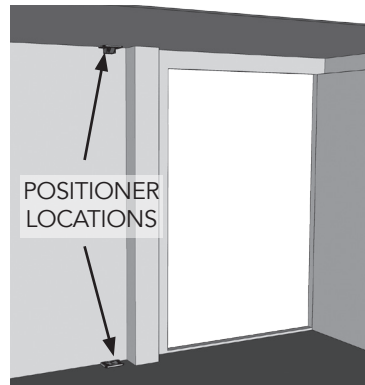
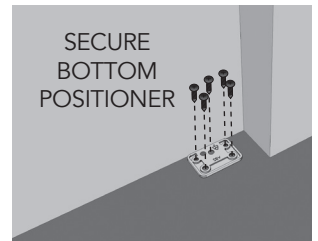

FIGURE 6.2



FIGURE 6.3



STEP 6

Secure the top and bottom telescoping shaft positioners to the cabinet using the positioner screws (See Figs 6.1, 6.2 and 6.3).



FIGURE 7

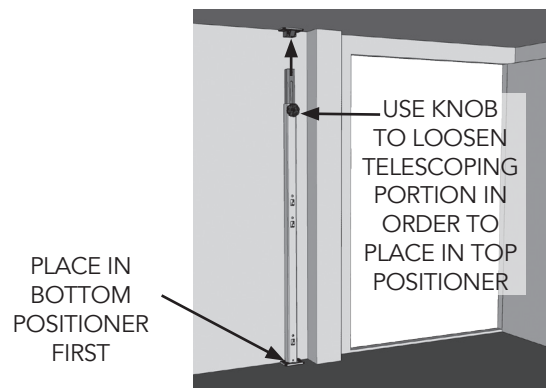

STEP 8

To hang the top shelf support from the telescoping shaft, use the hook that corresponds with the desired side bracket level (See Fig 8.1). Use the template from step 6 to punch holes corresponding with desired tray height (See Fig 8.2). Secure the side bracket to the cabinet side wall with side bracket screws (See Fig 8.3).



FIGURE 8.1

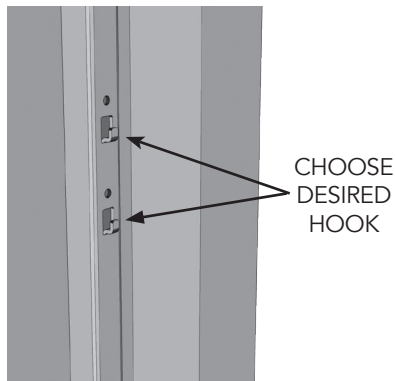
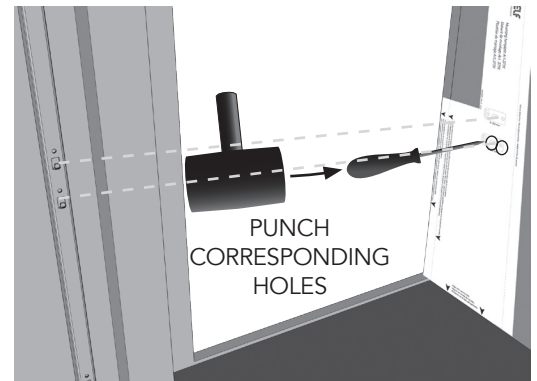

FIGURE 8.2



STEP 9

Place the support arm template from step 2 on top of the side bracket as shown in figure 9. This will give you the punch locations for the support arm belonging to the upper tray. Punch your holes using an awl and rubber mallet.



FIGURE 8.3

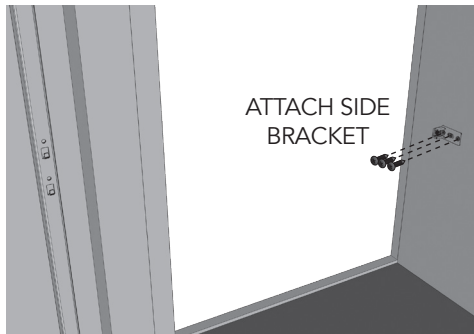
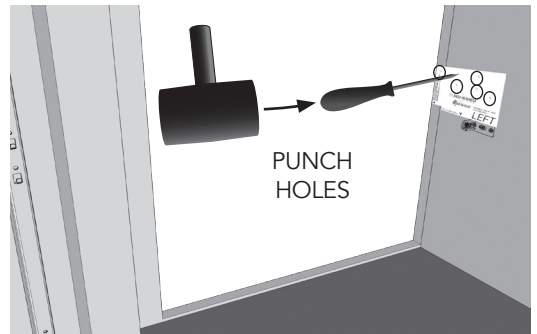

FIGURE 9



STEP 10

Using the provided support arm screws, secure the upper and lower support arms to the cabinet side wall (See Figs 10.1 and 10.2). At this time, insert the plastic caps into the support arms as shown.



FIGURE 10.1

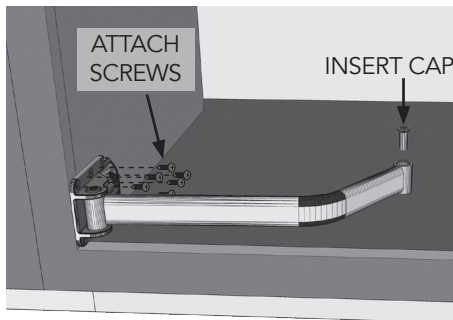
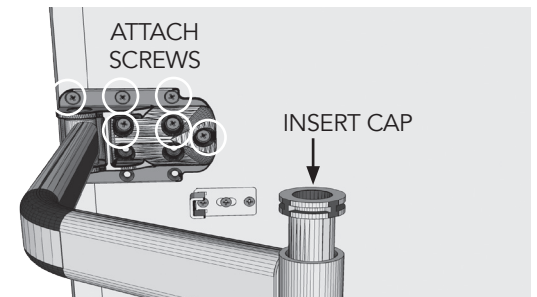

FIGURE 10.2



STEP 11

Secure the guide track to the cabinet floor using the guide track wood screws (See Fig 11).



FIGURE 11

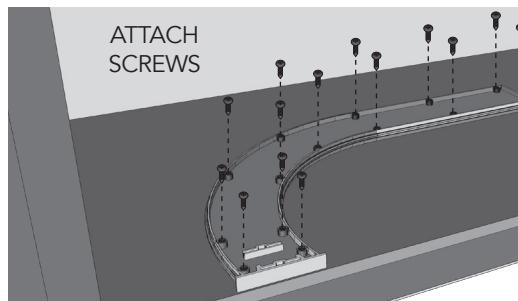

STEP 12

Secure the top shelf hardware to the side bracket (See Fig 12.1). Secure to the cabinet wall using the provided pivot screw (See Fig 12.2).



FIGURE 12.1

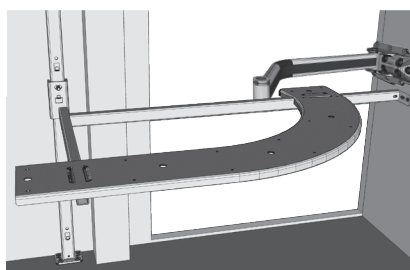
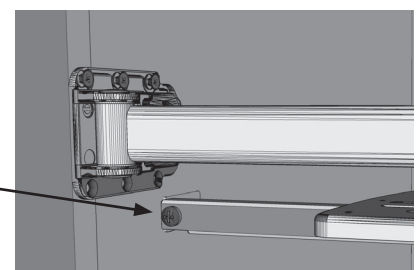

FIGURE 12.2



STEP 13

Using the guide track machine screws, secure the guide track to the top shelf hardware as shown in Figure 13.



OR

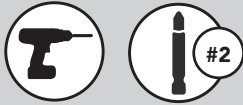

FIGURE 13

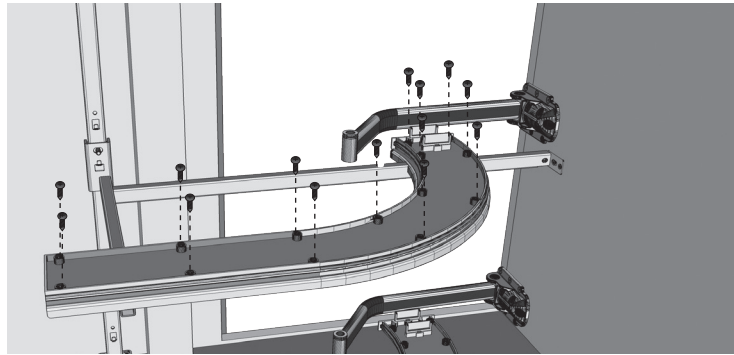
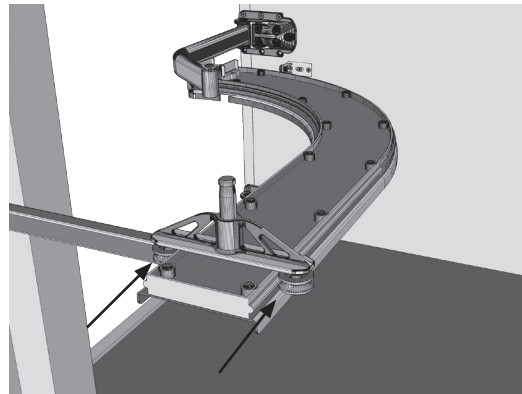
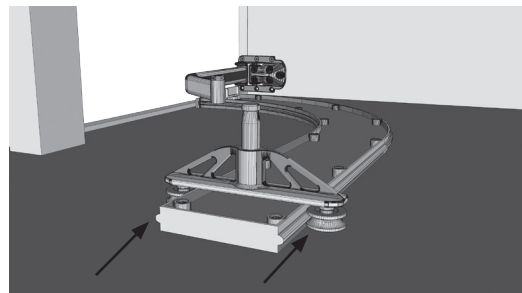

FIGURE 14



SLIDE ON
FROM REAR
OF TRACK

FIGURE 15



SLIDE ON
FROM REAR
OF TRACK

STEP 14

Slide the pivot guide onto the lower upper guide track (See Fig 14).

STEP 15

Slide the pivot guide onto the lower guide track (See Fig 15).

STOP

IF YOU INTEND TO INSTALL THE SOFT-CLOSE KIT, TURN TO PAGE 10 AT THIS TIME. OTHERWISE, PROCEED TO STEP 16 AND CONTINUE YOUR INSTALLATION.

STOP

STEP 16

Align the top tray over the top of the pivot guide and support arm (See Fig 16). Insert the tray into the corresponding attachments and press firmly into place. Repeat for the top tray. Your installation is now complete.

FIGURE 16

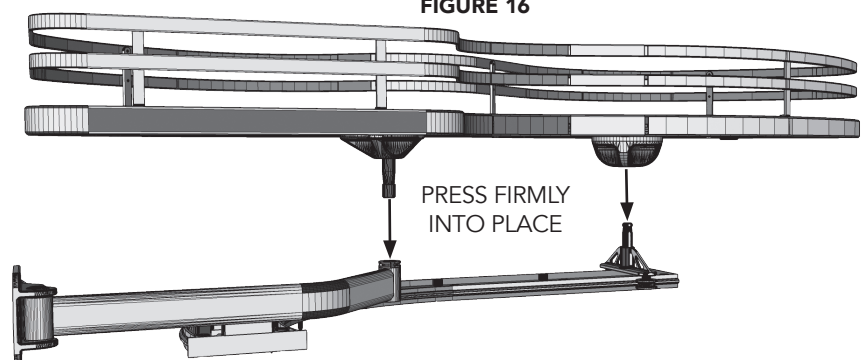

IMPORTANT NOTE:

DO NOT REMOVE SOFT-CLOSE PISTON FROM ITS RED CASE UNTIL THE PISTON IS ATTACHED TO BOTH THE CLOUD TRAY AND THE SUPPORT ARM!

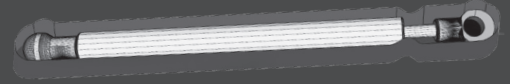

INSTALLING THE SOFT-CLOSE KIT

STEP 1

Turn over the tray and locate the 3 pre-drilled holes. Using the ball stud screws, attach the soft-close tray ball stud to the bottom of the tray, utilizing the aforementioned 3 holes (See Figures 1.1 and 1.2).

NOTE: For 2-tray systems, you will repeat each step for every tray.



#2

STEP 2

Attach the Support Arm Soft-Close Piece on the support arm. Identify the support arm ball stud attachment location on the support arm soft-close mechanism and attach the support arm ball stud (See Figure 2).



FIGURE 1.1

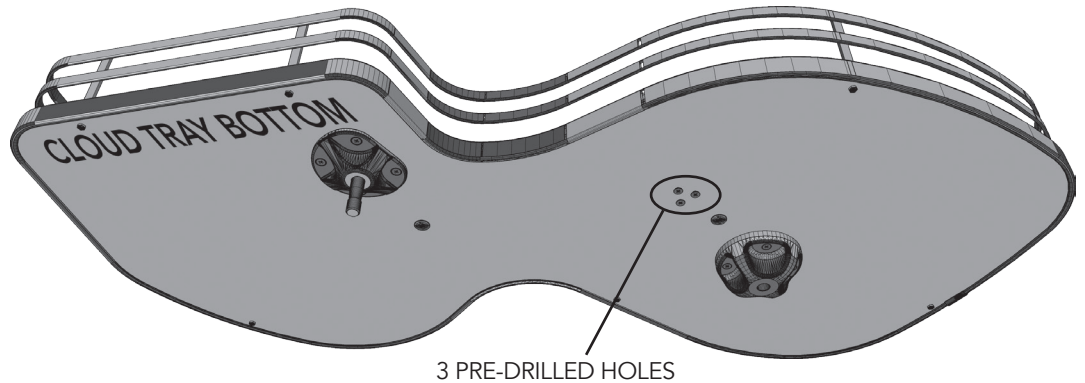

FIGURE 1.2

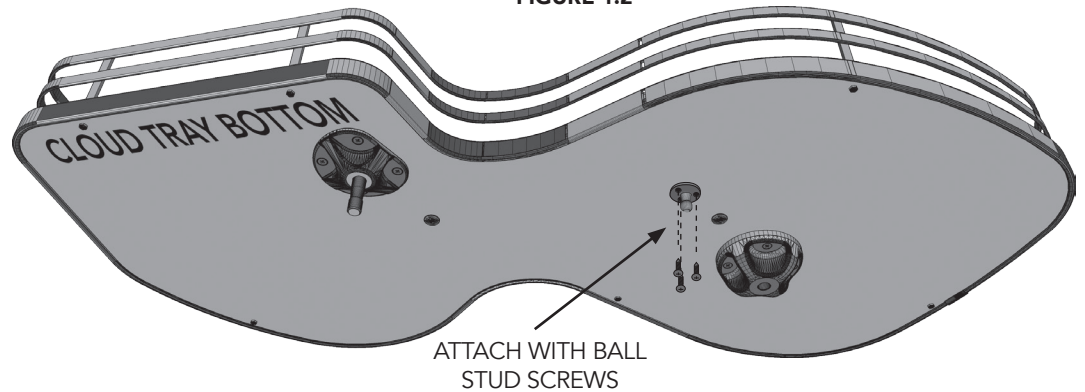
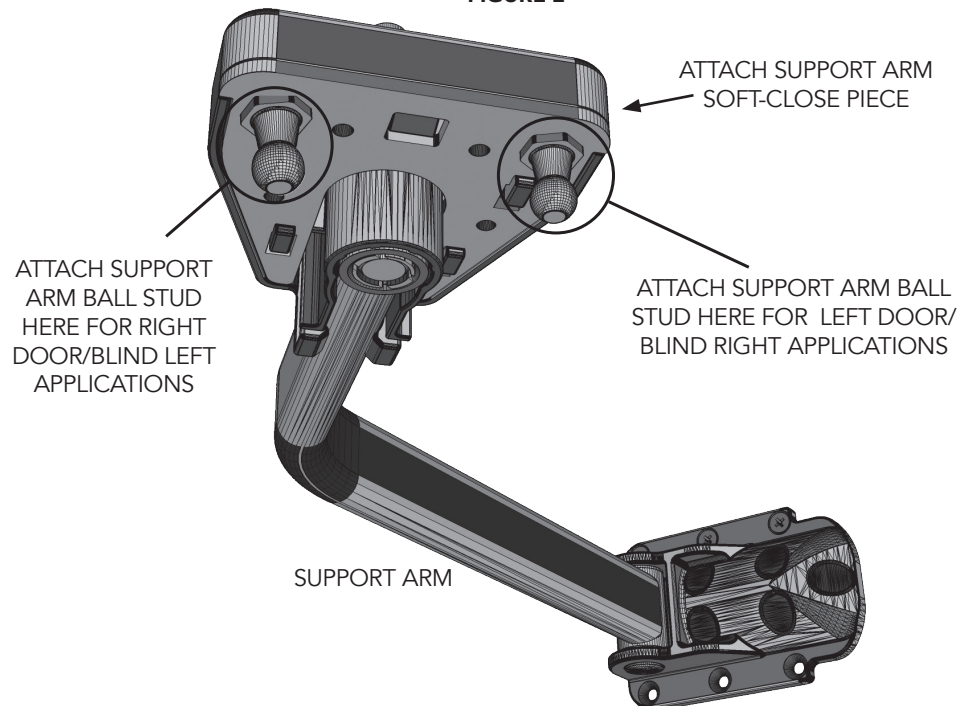

FIGURE 2



STEP 3

Align the tray over the top of the pivot guide and support arm. Insert the tray into the corresponding attachments and press firmly into place (See Figure 3).

FIGURE 3

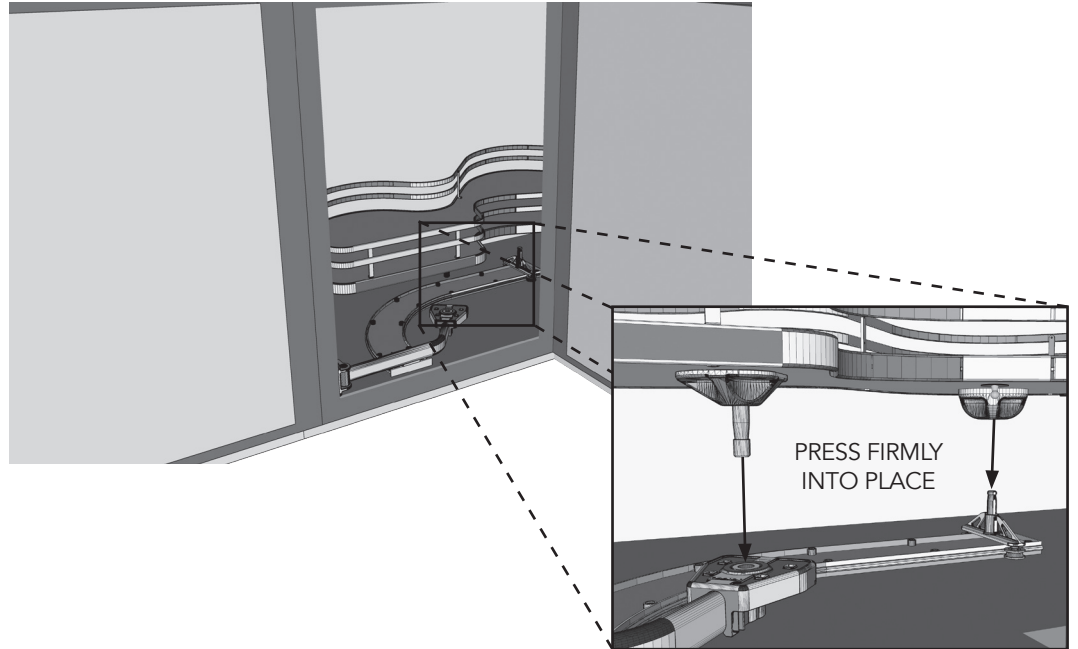

STEP 4

For the orientation of how the piston is turned in order to attach. Ensure the thin black portion of the piston is facing toward the cabinet opening (See Figure 4).

FIGURE 4

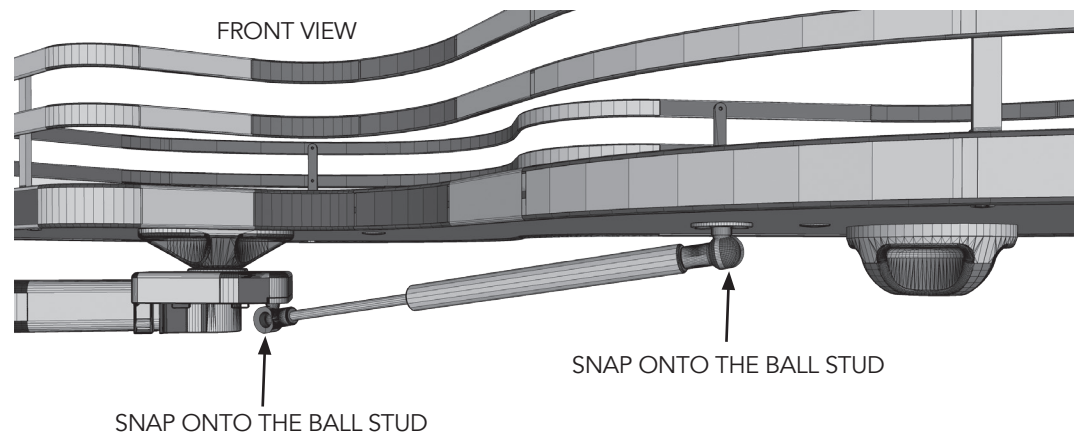

STEP 5

Snap the piston onto the ball studs (See Figure 4). The tray will need to be approximately halfway in the open position when attaching.

STEP 6

Once the piston has been attached, open and close the unit a few times to ensure it works properly. At this time, The red piston case should detach automatically.



12400 Earl Jones Way
Louisville, KY 40299
rev-a-shelf.com
Customer Service: 800-626-1126