



# Staples

- Non-Insulated
- Made of Steel
- Used for Armored & NM Cable
- Sharp Tips



CAT. NO.	CABLE RANGE & TYPES	DIMENSIONS		BOX QTY	CASE QTY
		WIDTH	DEPTH		
19556	14-2, 12-2 NM & BX CABLE	1/2"	1-1/16"	100	2,000
19555	14-2, 12-2 NM & BX CABLE	1/2"	1-1/16"	500	5,000
19554	14-2, 12-2 NM & BX CABLE	1/2"	1-1/16"	-	5,000/PAIL
19553	14-3, 12-3, 10-3 NM & BX CABLE	9/16"	1-1/8"	100	2,000
19552	14-3, 12-3, 10-3 NM & BX CABLE	9/16"	1-1/8"	500	5,000
19551	14-3, 12-3, 10-3 NM & BX CABLE	9/16"	1-1/8"	-	5,000/PAIL

# Cable Stacker

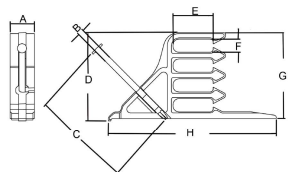

- Accepts a wide range of NM cables
- Angled nail allows easy installation from any direction regardless of stud positioning and spacing
- Keeps a professional look in exposed areas
- Cables snap easily in between tines for a secure hold
- Makes cable identification simple
- Also used with CATV, Telephone, Instrumentation and Security Cables
- Material: Polypropylene

CAT. NO.	DIMENSIONS								BAG QTY	CASE QTY
	A	B	C	D	E	F	G	H		
21757	0.47"	0.11"	1.93"	1.72"	0.78"	0.26"	1.67"	3.26"	25	1,000

Staples, Cable Stackers, Nail Straps, Nail Plates

# Nail Straps - Heavy Duty - Rigid IMC & EMT

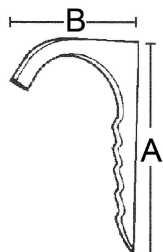

- Secures Rigid, IMC & EMT Conduits thru 1" Diameter
- Zinc Plated Stamped Steel
- Wood or Masonry Applications

CAT. NO.	TRADE SIZE	DIMENSIONS		INNER BOX	OUTER BOX
		A	B		
19482	1/2"	2.13"	1.10"	100	1,000
19483	3/4"	2.13"	1.20"	100	1,000
19484	1"	2.25"	1.50"	50	500

# Nail Plates

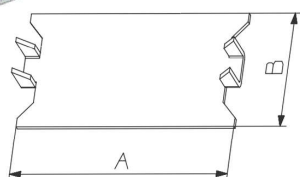
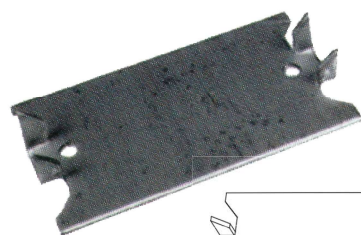

- Used to protect internal wire runs from nail punctures
- Hammer On
- Zinc Plated Stamped Steel

CAT. NO.	TRADE SIZE	DIMENSIONS		INNER BOX	OUTER BOX
		A	B		
19542	1-1/2" X 2-1/2"	2.5"	1.5"	100	500