

TABLE OF CONTENTS

	Important Guidelines	Page 4
	Parts Diagram	Page 5
ORIGINAL	Knob on Drawer	Page 6
	Handle on Drawer	
	Knob on Door	Page 7
	Handle on Door	
	Drilling Hinge Plate Holes	Page 8
	Helpful Hints	
	Accessories	Page 9
	Shaker Drawer Spacers	
PRO	Rapid Center Extension	Page 10
	Large Handle on Door	Page 11
MAX	Large Handle on Drawer	Page 12
	Drilling Shelf Pin Holes	Page 13
	Upgrades & Products	Page 14
	Double Hole Drill Guide Set (16/32mm C-C Pattern)	Page 15

SAFETY GUIDELINES

- Read this manual fully before using the tool and operate this tool according to these instructions.
- Operating this tool before understanding safe and proper use could result in personal injury.
- Always wear certified safety equipment including eye, hearing, and respiratory protection.
- The drill bit is sharp. Handle with care. Avoid hand positions where a slip could cause contact with the bit.
- Do not operate this tool or any machinery while under the influence of drugs, alcohol, or medications.



WARNING: Drilling, sawing, sanding or machining wood products can expose you to wood dust, a substance known to the State of California to cause cancer. Avoid inhaling wood dust or use a dust mask or other safeguards for personal protection. For more information go to www.P65Warnings.ca.gov/wood.



SCAN FOR DIGITAL
INSTRUCTIONS

IMPORTANT

FOLLOW THESE GUIDELINES WHILE USING THIS TOOL

- Confirm hole spacing by screwing your hardware through bushings after tightening drill guides into position.
 - Prior to use check all dimensions before drilling and confirm measurements by drilling on scrap wood.
 - For high gloss or delicate finishes, use tape on tool or work piece to protect finish.
 - Ensure thumb screws remain tight by checking after each time you drill into jig.
 - Always use care when handling this tool, it is a precisely calibrated instrument. Take care to avoid accidental damage, do not drop or throw this against hard surfaces.
 - Prior to use check jig for any imperfections or defects that may have occurred during prior usage, transport, or manufacturing that could result in inaccurate hardware placement or damage to workpiece. If you find any issues with your jig upon inspection contact us before use.
- ⚠ Do not use pliers to tighten thumb screws, they should only be hand-tightened.
- ⚠ Do not adjust any screws except for silver thumb screws, all other screws have been set and tightened to factory specifications to ensure accuracy.

CHOOSE YOUR CABINET HARDWARE JIG

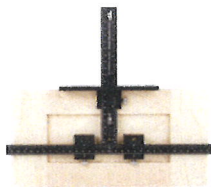

ORIGINAL

- ✓ Fast, Accurate Hardware Installation in Seconds
- ✓ Any Door & Drawer + Hardware up to 12"

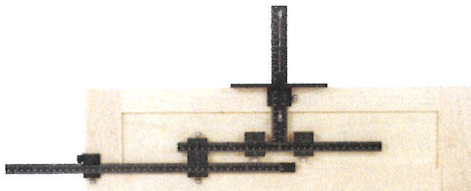

PRO

- ✓ The Original, *plus*:
- + Rapid Drawer Front Centering
- + Quick Repeatable Door Settings

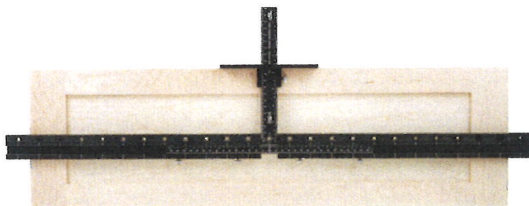

MAX

- ✓ The Pro, *plus*:
- + Hardware up to 38" (965mm)
- + Shelf Pins with 32mm Spacing

Want to level up? Visit our website: www.TruePositionTools.com

PARTS DIAGRAM

INCLUDED PARTS VARY BY MODEL

INCLUDED IN ALL JIGS



MAX

PRO

ORIGINAL

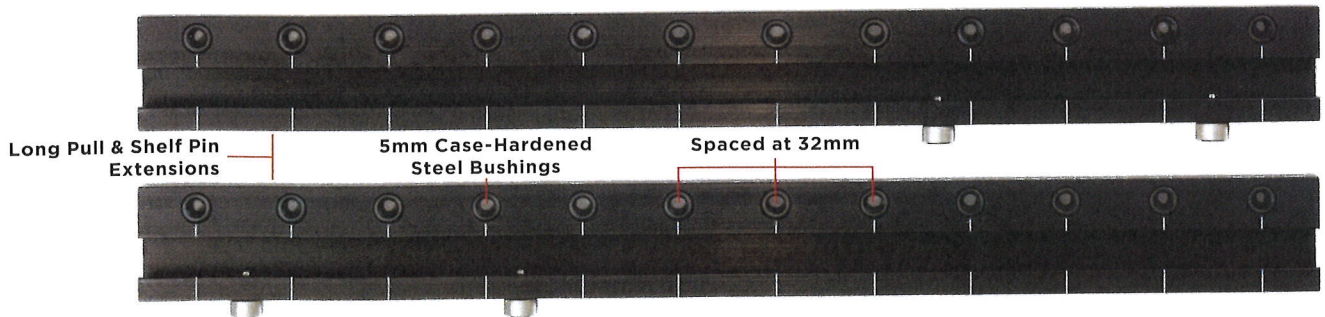
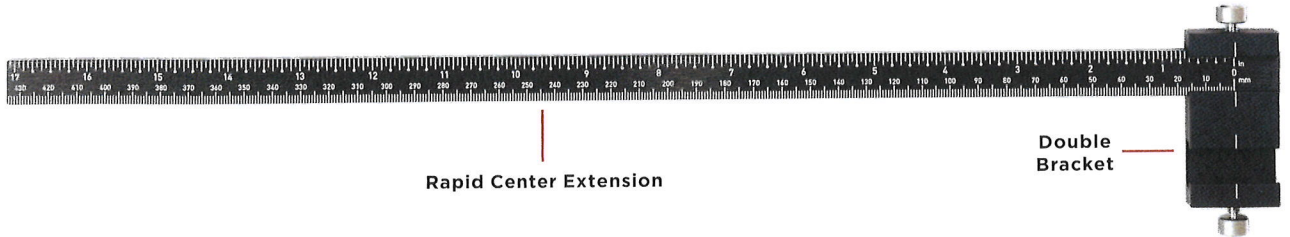
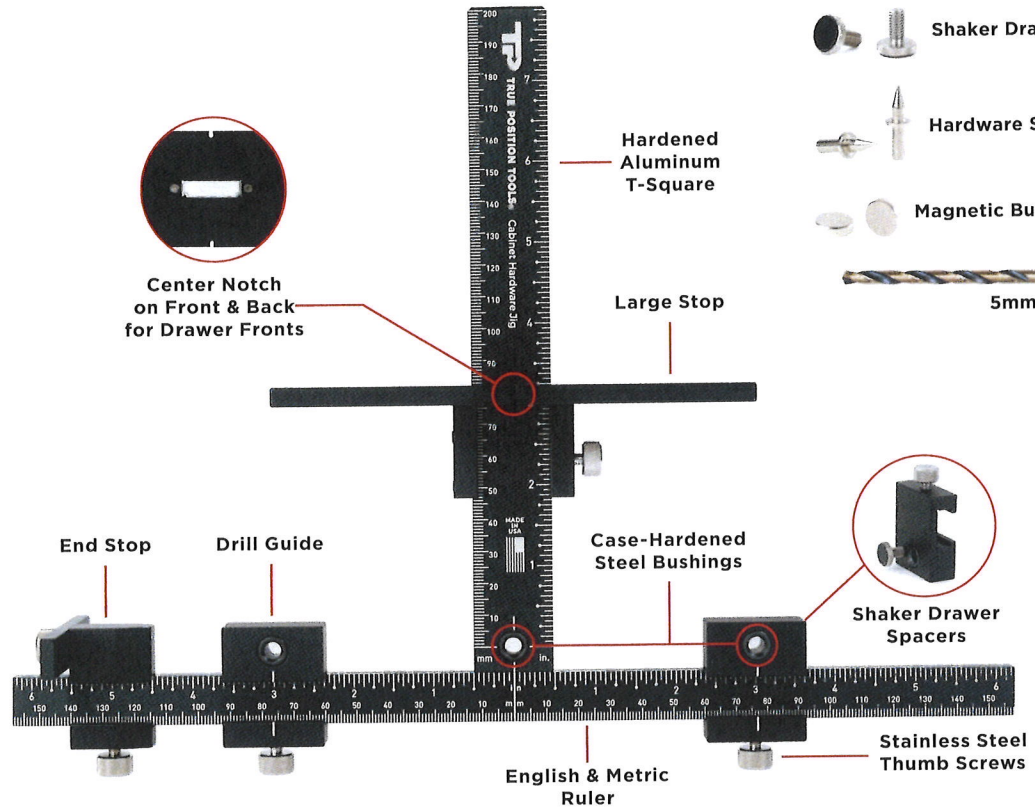

KNOB ON DRAWER



1 Place hardware to find position you like. (We are centering on width and height. Measure and mark if needed for non-centered applications.)



2 Measure drawer width to find center.

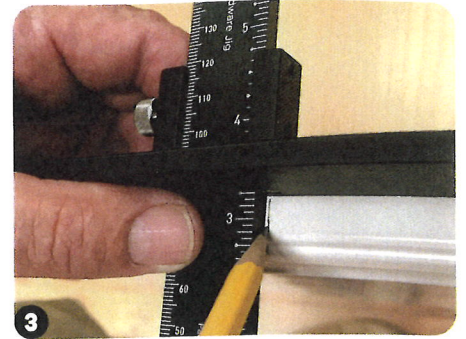

3 Mark center on top of drawer.

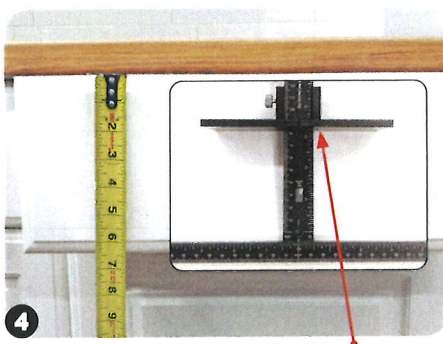

4 Measure height of drawer and set **Large Stop** at half of drawer height (if centering).

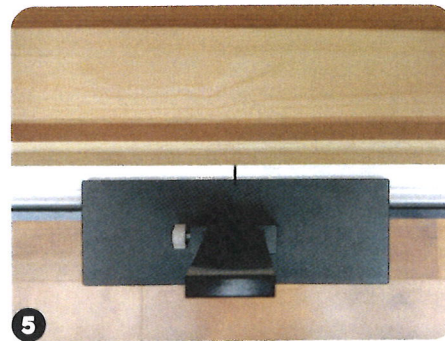

5 Line up notch on center of **Large Stop** with center mark at top of drawer then push tool flush against drawer face.

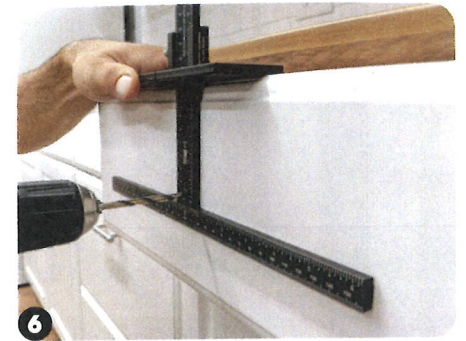

6 Hold securely and drill hole using fixed center drill bushing (**Large Stop** reversed for stability).

HANDLE ON DRAWER

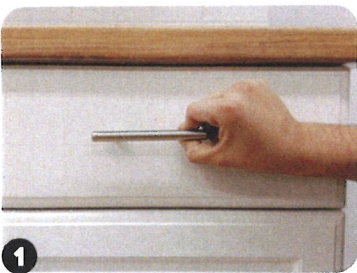

1 Place hardware to find position you like. (We are centering on width and height. Measure and mark if needed for non-centered applications.)

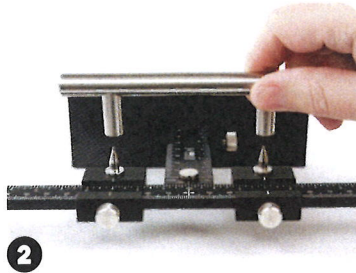

2 Place Hardware Spacing Pins in bushings, keep Drill Guides loose. Set hardware onto spacing pins and press down until fully seated. Tighten thumb screws to set spacing. Ensure measurement is equal on both sides of the jig.



3 Measure drawer width to find center.

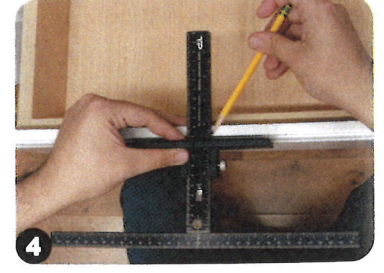

4 Use half of measurement from Step 3 to mark center on top of drawer.

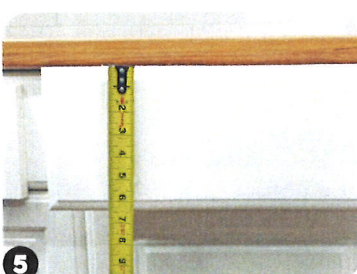

5 Measure height of drawer front.

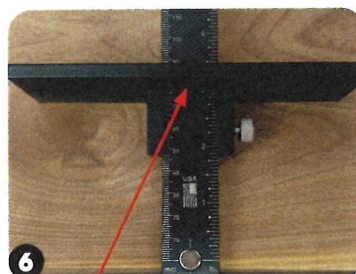

6 Set **Large Stop** to half of measurement from Step 5 (if centering).

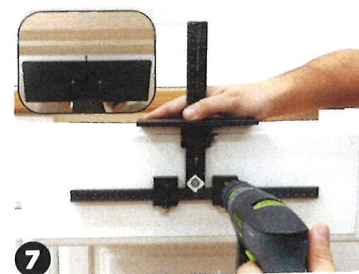

7 Line up notch on **Large Stop** with mark from Step 4, then drill.

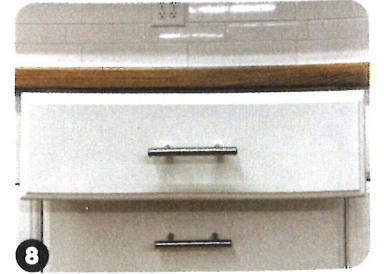

8 Install handle and repeat process for additional drawers.

ORIGINAL

KNOB ON DOOR

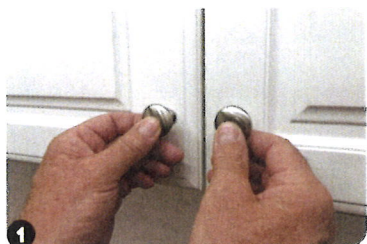

1 Place hardware (measure as needed) to find position you like; mark hole location



2 Measure from bottom of door to mark.

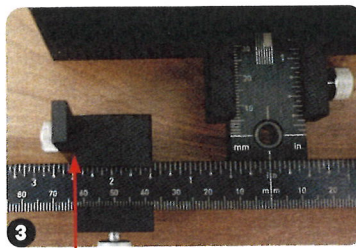

3 Set **End Stop** to measurement from Step 2 and tighten.



4 Measure from side of door to mark.

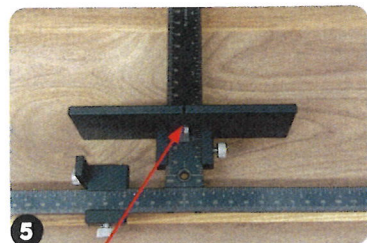

5 Set **Large Stop** to measurement from Step 4 and tighten.

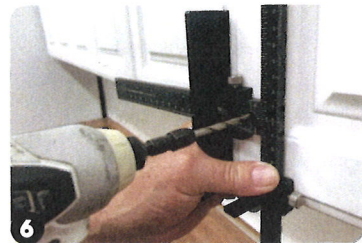

6 Position tool with stops as shown and drill hole through drill bushing.

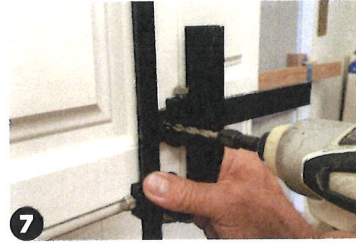

7 Flip tool to its reverse side, place on opposite door and repeat.



8 Install knob and repeat process for additional doors.

HANDLE ON DOOR

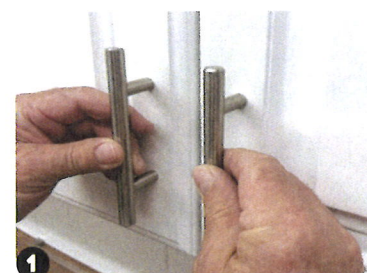

1 Place hardware (measure as needed) to find position you like; mark bottom hole location.

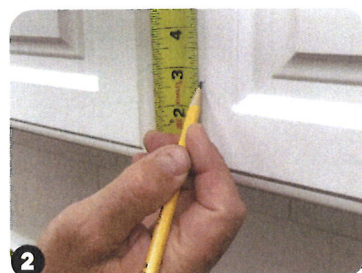

2 Measure from bottom of door to mark.

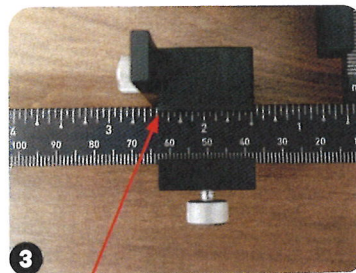

3 Set **End Stop** to measurement from Step 2 and tighten.



4 Measure from side of door to mark.

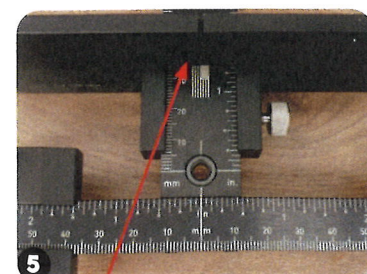

5 Set **Large Stop** to measurement from Step 4 and tighten.

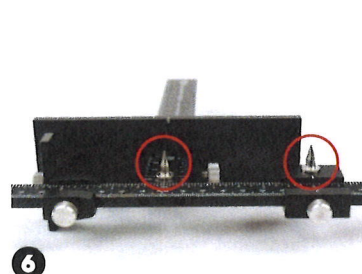

6 Place **Hardware Spacing Pins** in bushings, keep Drill Guide loose.

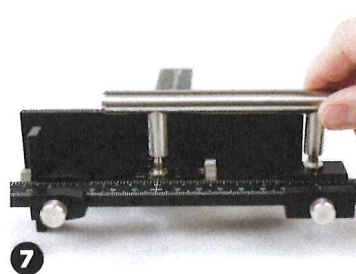

7 Set hardware onto spacing pins and press down until fully seated. Tighten thumb screws to set spacing.

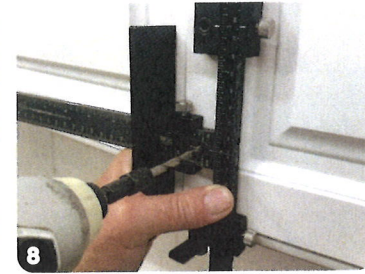

8 Hold securely and drill through fixed center bushing for bottom hole.

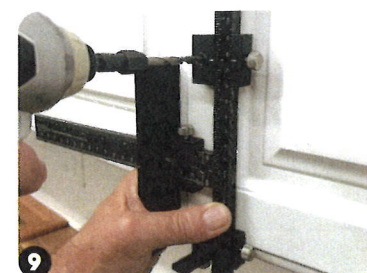

9 Drill through Drill Guide for top hole.

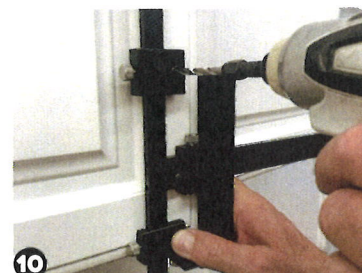

10 Flip tool to its reverse side, place on opposite door and repeat.

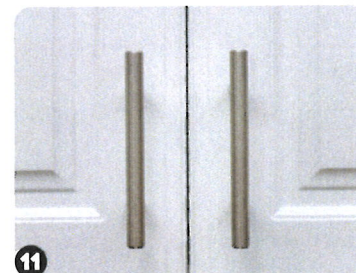

11 Install handle and repeat process for additional doors.

DRILLING HINGE PLATE HOLES

32MM SPACING ALLOWS FOR DRILLING CONCEALED HINGE MOUNTING PLATE HOLES

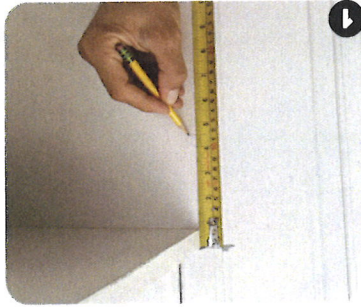

1 Mark center of hinge plate.

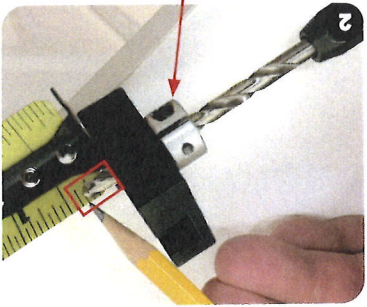

2 Set location of Stop Collar to drill depth using a Drill Guide as spacer and tighten with allen key.

(Drill depth varies depending on screw length and cabinet material thickness.)

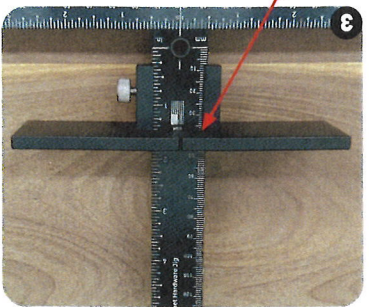

3 Set Large Stop to 37mm (Industry standard).

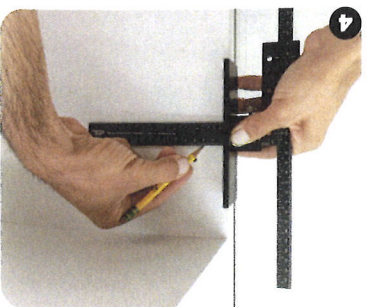

4 Place Large Stop edge against cabinet face and use as a square to draw a line at mark from Step 1.

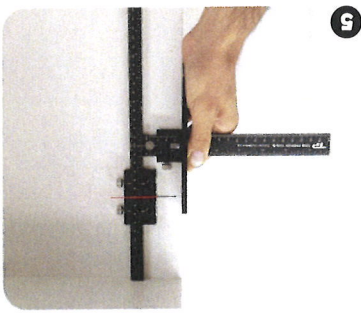

5 Place two Drill Guides side by side to achieve 32mm spacing. Position tool with Large Stop and T-Square firmly against cabinet surface. Adjust Drill Guide centers to previous mark and tighten. Drill first set of hinge plate holes.

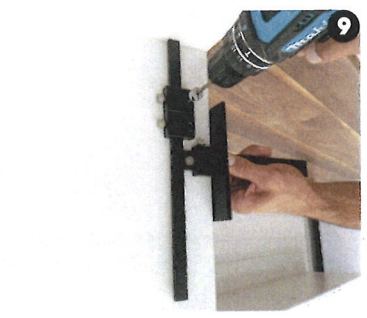

6 Flip tool to bottom of cabinet, position tool with Large Stop and T-Square firmly against cabinet surface, and drill second set of holes.

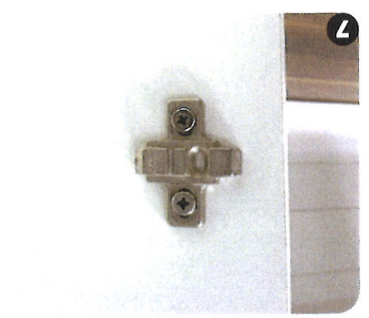

7 Install hinge mounting plate and repeat process for additional hinges.

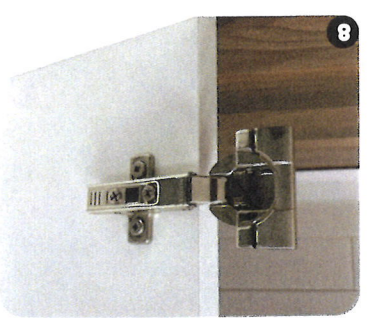

8 Hinge mounting plate with hinge attached, ready for door installation.

HELPFUL HINTS

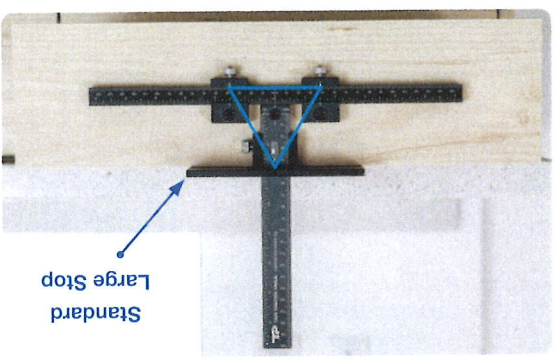

Using jig in the Standard Large Stop configuration provides 3 points of support in most situations.

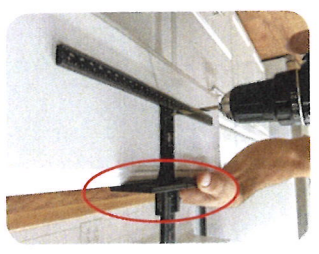

Only Reverse Large Stop when additional clearance or stability is required.

See Examples:

Knob on Drawer - Page 6
Large Handle on Door - Page 11

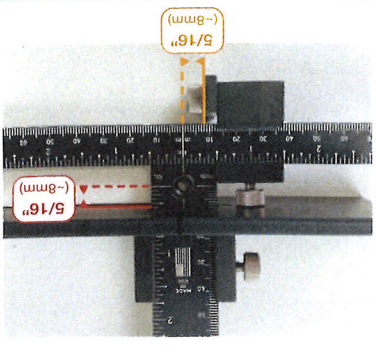

Reversing Large Stop or End Stop can produce down to a 5/16" (~8mm) minimum spacing from surface edges.

ACCESSORIES

SHAKER DRAWER SPACERS

PROVIDE STABILITY WHEN DRILLING RECESSED DRAWER FRONT PANELS

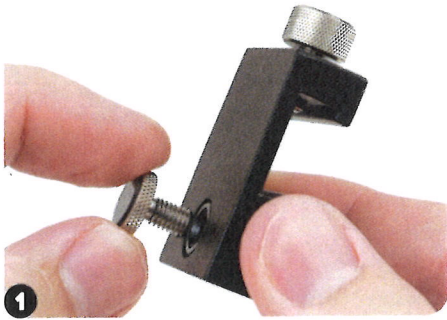

1 Remove Drill Guide and thread Shaker Drawer Spacer into reverse side.

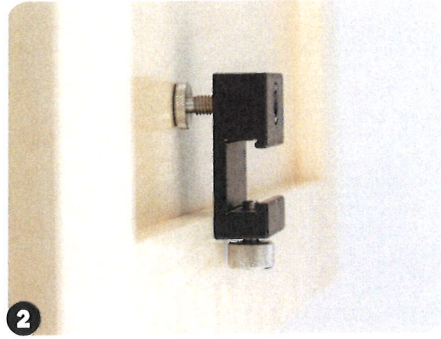

2 Place Drill Guide on drawer front with Spacer on recessed portion. Adjust Spacer until it reaches the surface of the inset panel and the Drill Guide is level.

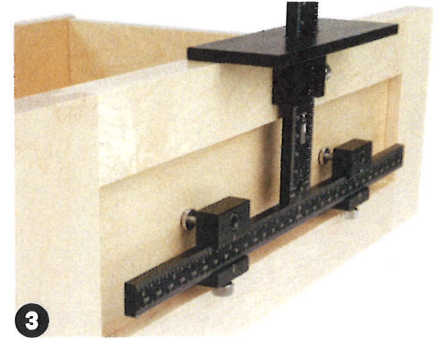

3 Return Drill Guides to appropriate measurements and drill holes.

MAGNETIC BUSHING COVERS

PREVENT DRILLING THROUGH INCORRECT HOLES BY COVERING UNUSED BUSHINGS

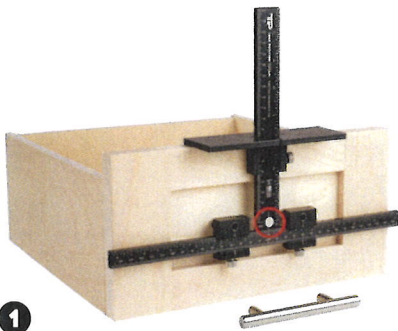

1 For example, when installing pulls on drawers, use **Magnetic Bushing Cover** to cover center hole.

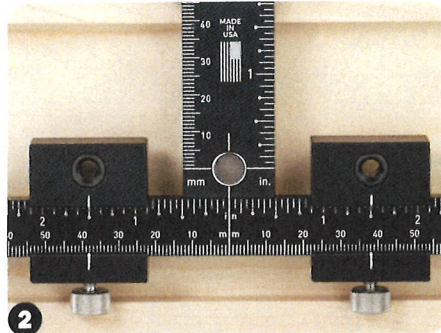

2 Close-up of Magnet Bushing Cover placement.

HARDWARE SPACING PINS

FIND AND SET CABINET PULL SPACING QUICKLY AND ACCURATELY

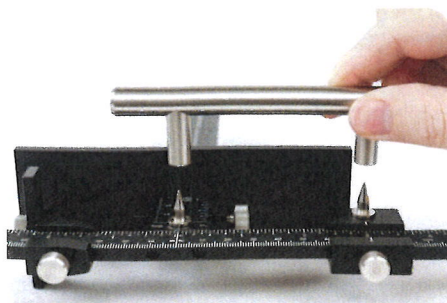

1

For Doors: Place Hardware Spacing Pins in bushings, keep Drill Guide loose. Set hardware onto Spacing Pins and press down until fully seated. Tighten thumb screws to set spacing.

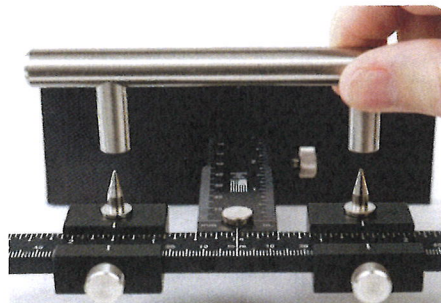

2

For Drawers: Place Hardware Spacing Pins in bushings, keep Drill Guides loose. Set hardware onto Spacing Pins and press down until fully seated. Tighten thumb screws to set spacing. Ensure measurement is equal on both sides of the jig.

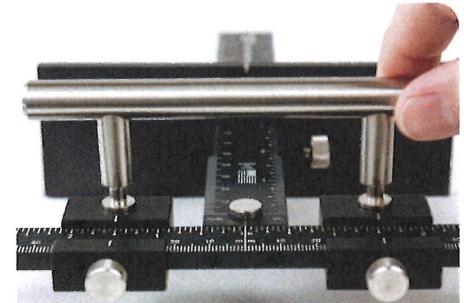

RAPID CENTER EXTENSION ON DRAWER

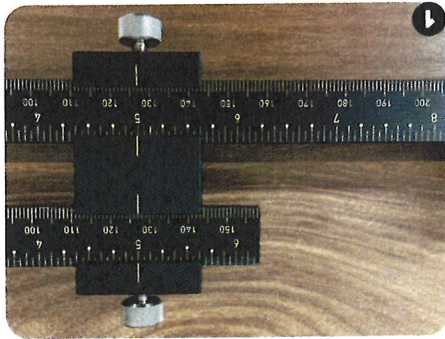

1 Connect Rapid Center Extension and Double Bracket to T-Square at 5" mark to extend length of ruler to 16".

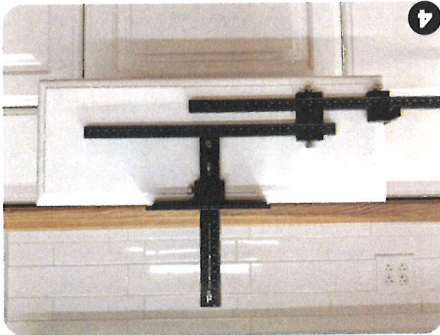

4 Set the End Stop to half of the drawer width measurement from Step 3.

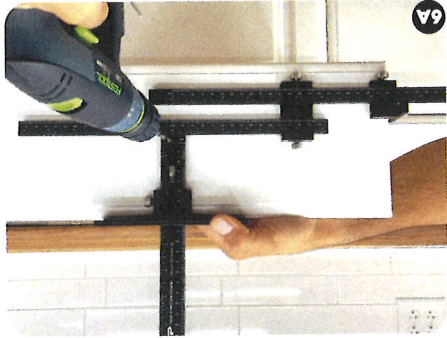

6A For Knobs: Drill through center bushing.

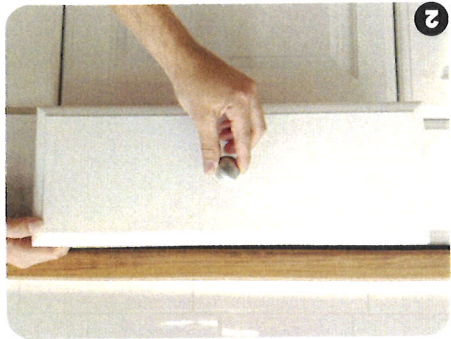

2 Place hardware to find position you like. (We are centering on width and height. Measure and mark if needed for non-centered applications.)

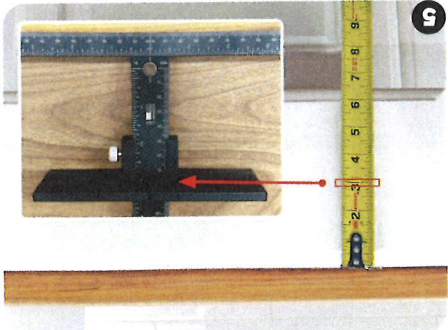

5 Measure height of drawer and set Large Stop to desired location and tighten thumb screws (half of measurement, if centering).

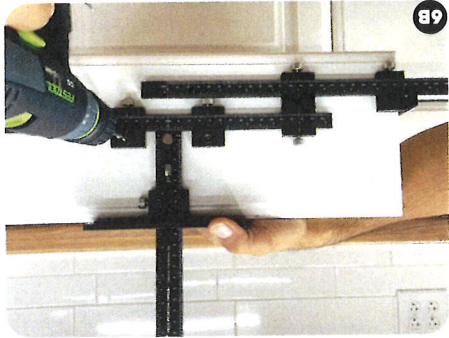

6B For Handles: Measure hardware and tighten Drill Guides to match hardware measurement, then drill (refer to Page 6, Handle on Drawer section if more information is needed).

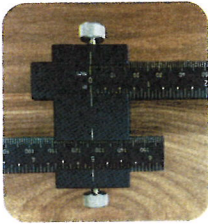

1 Align 5" mark on T-Square with the 0" mark on the Rapid Center Extension, as shown in image.

2 Measure drawer width, then **DIVIDE** in half and **SUBTRACT 5"**
EXAMPLE
For 40" Drawer Front
20" (half of 40") - 5" = 15"
End Stop is then placed on 15" mark

FOR DRAWERS LARGER THAN 32"

PRO TIP

If handle pattern interferes with Double Bracket, align Bracket and Rapid Center Extension to number on T-Square that doesn't interfere (aligned at 2" in above image)

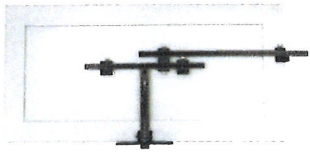

PRO TIP

Measure drawer width and divide in half to find the exact center.

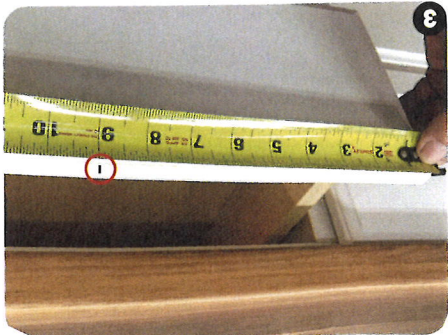

MAX

LARGE HANDLE ON DOOR

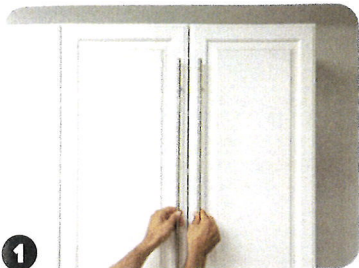

1 Place hardware (measure as needed) to find position you like; mark bottom hole location with pencil.

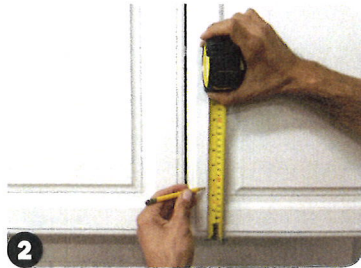

2 Measure from bottom of door to mark.

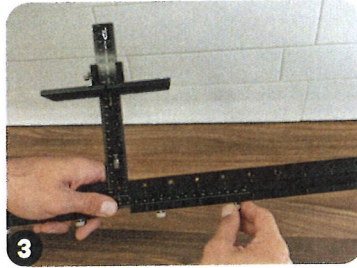

3 Slide the Long Pull Extensions all the way onto the T-Square, and tighten all four thumb screws.

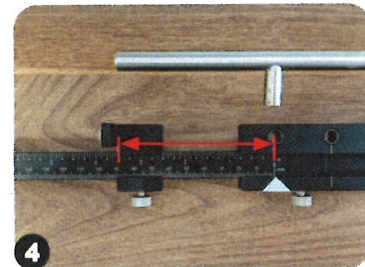

4 Attach Rapid Center Extension and set at index mark for bottom hole. Set End Stop to measurement from Step 2.



5 Measure from side of door to mark.

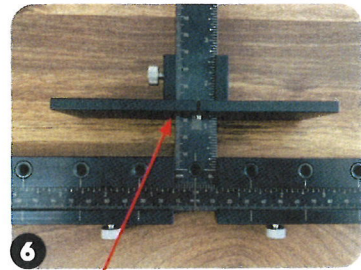

6 Set **Large Stop** to measurement from Step 5 and tighten thumb screws. (If needed, reverse Large Stop for additional clearance).

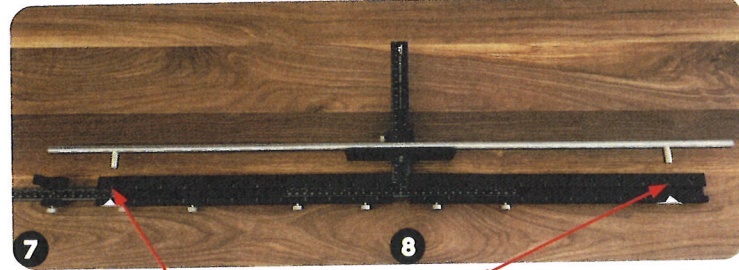

7 Match the **bottom hole** on hardware to bottom hole on Long Pull Extension and mark with tape.

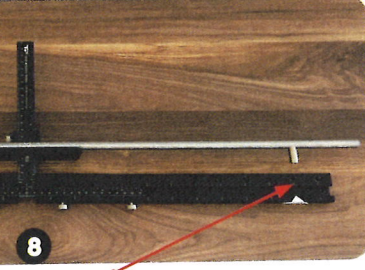

8 Match **top hole** on hardware to matching hole on Long Pull Extension; mark hole with tape.

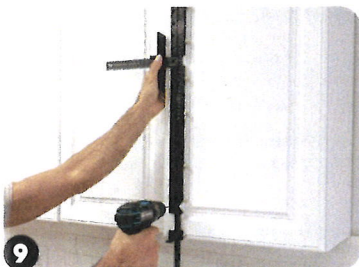

9 Hold both stops firmly against door and drill bottom hole.



10 Drill top hole.



11 Flip tool to its reverse side, place on opposite door and repeat drilling.



The majority of large pulls fit perfectly into our Long Pull Extension hole pattern, as large pulls typically come in 32mm increments — the same increments as our hole pattern!

TAKE YOUR JIG TO THE NEXT LEVEL

Find these products and more at www.TruePositionTools.com



UPGRADE TO MAX

LONG PULL & RAPID CENTER EXTENSION SET

If you bought the Original CHJ and need to install long handles or add shelf pins on site, the Long Pull & Rapid Center Extension Set allows you to do just that.

TP-CHJ-LPRC

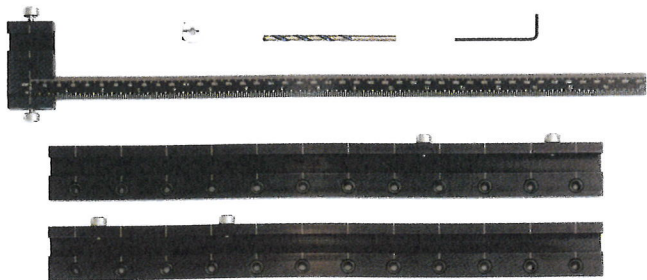

UPGRADE TO PRO

RAPID CENTER EXTENSION

Speed up hardware installation by using the Rapid Center Extension, eliminating the need to center your jig on each drawer. Attach for quicker centering on wide drawer fronts and tall doors. Allows for adjustable starting point for line boring in assembled cabinets.

TP-CHJ-RC

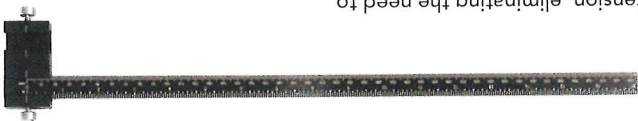

CABINET LIGHTING

CABINET LIGHT JIG

Simplify cabinet lighting with our revolutionary Cabinet Light Jig.

TP-CLJ

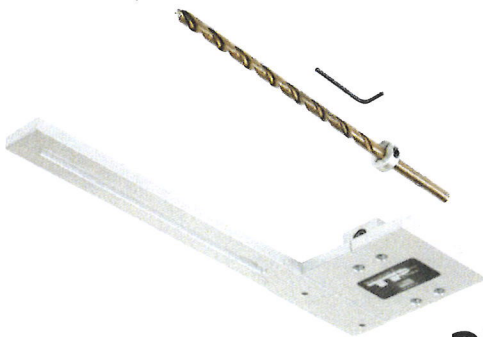

The Cabinet Light Jig installs light wires within the structural panels of the cabinet, eliminating the need for a light rail or double bottom.



ADD-ON

DOUBLE HOLE DRILL GUIDE SET (16mm & 32mm Pattern)

For installation of 16mm & 32mm Center-to-Center pulls and knobs on cabinet doors and drawer fronts. These Drill Guides attach to **ORIGINAL** (TP-CHJ), **PRO** (TP-CHJ-PRO), and **MAX** (TP-CHJ-MAX) Cabinet Hardware Jigs.

TP-CHJ-DHG

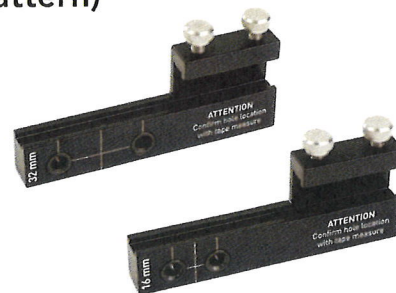

Double Hole Drill Guide Instructions: Installing 16mm/32mm C-C Hardware

DRAWER INSTALL

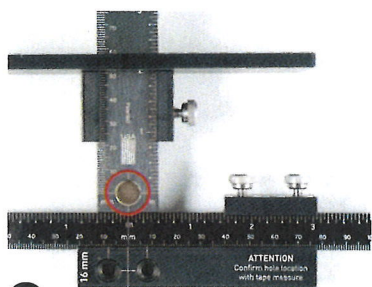

1

Attach and center Double Hole Drill Guide attachment to center line on T-Square. Cover unused bushing with **Magnet**.

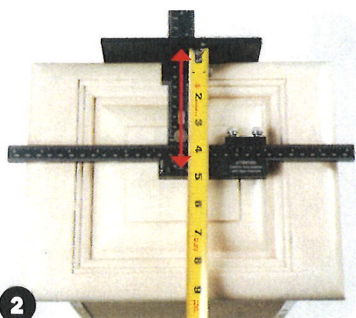

2

Measure height of drawer front, adjust Large Stop to desired height by referencing the center line on Drill Guide.

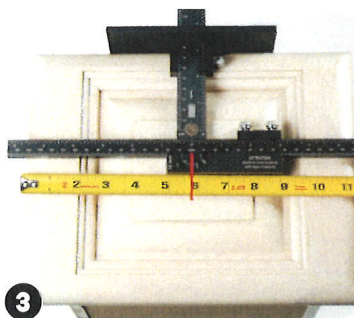

3

Center T-Square on drawer front referencing center line on Drill Guide.

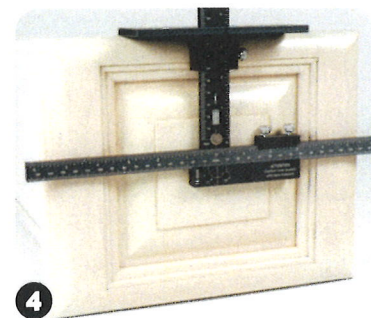

4

Secure jig and drill. Install hardware.

DOOR INSTALL

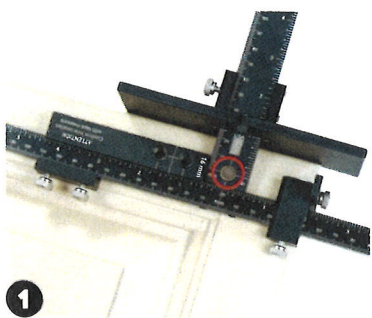

1

Attach Double Hole Drill Guide attachment to T-Square with the End Stop on the opposite end. Cover unused bushing with **Magnet**.

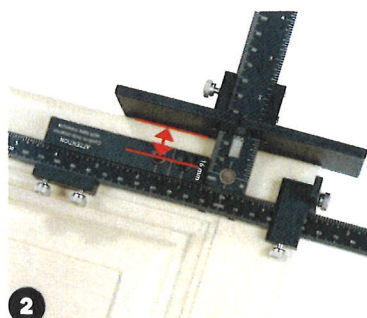

2

Adjust Large Stop to desired distance from edge of door to the center line on Drill Guide attachment.

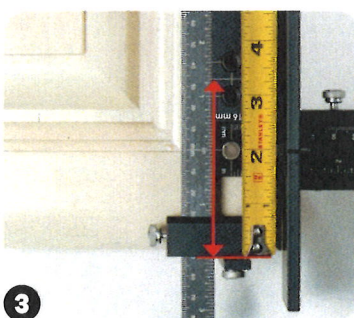

3

Adjust End Stop to desired distance from hardware holes.

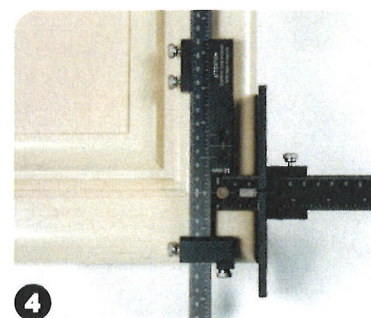

4

Secure jig and drill. For paired doors, simply flip the jig over to quickly repeat settings and drill. Install hardware.